

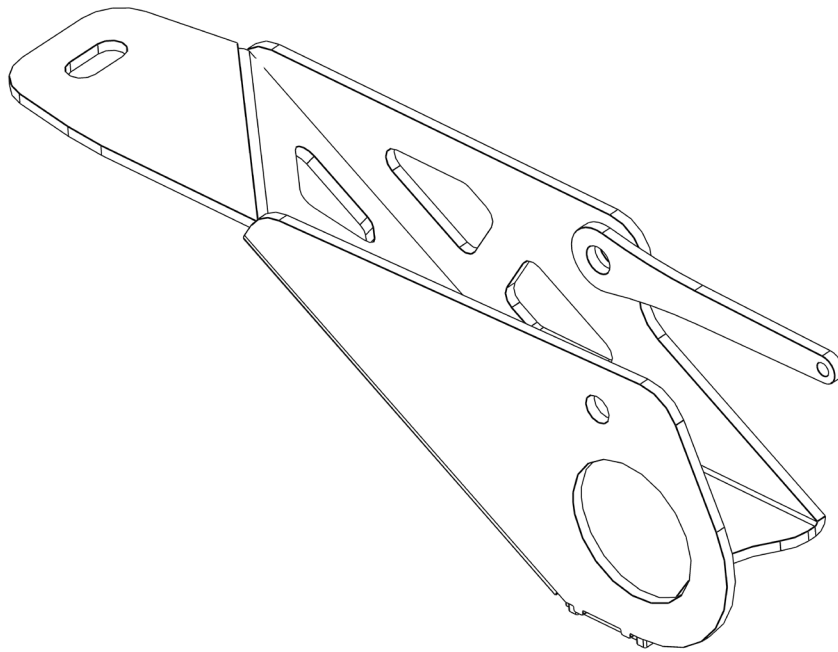

6TH GEN BRONCO REAR LOWER CONTROL ARM SKIDS

INSTALL INSTRUCTIONS



Please read the mounting instructions below carefully before attempting to install.

Be sure to check out the install video on the product page, if available.

Thank you for purchasing from JcROffroad! Checkout our website, www.jcroffroad.com for other great off-road products. Be sure to rate and review our product online. If you have any questions or are missing parts, please don't hesitate to call us at 269-353-1184!

INCLUDED HARDWARE

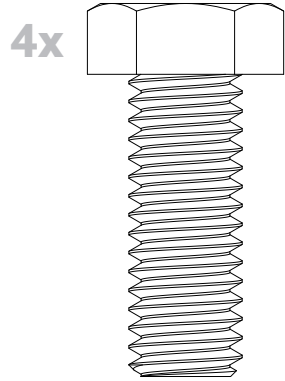

3/8"-16 x 1"
Hex Head

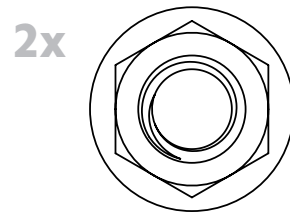

3/8"-16
Flange Nut

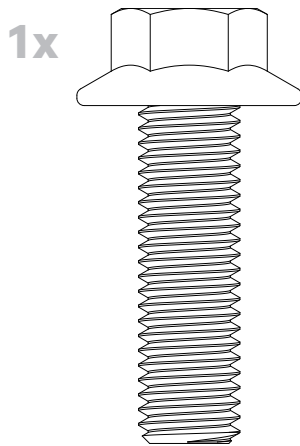

1/2"-13 x 1"
Thread Cutting Hex

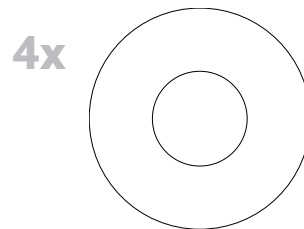

5/16"
Flat Washer

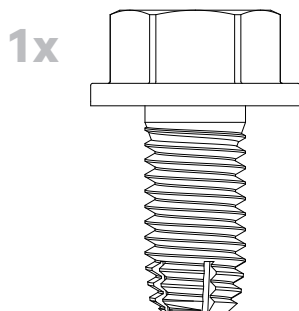

M12 x 1.75mm
Flanged Hex Head

INCLUDED PARTS

1L/1R

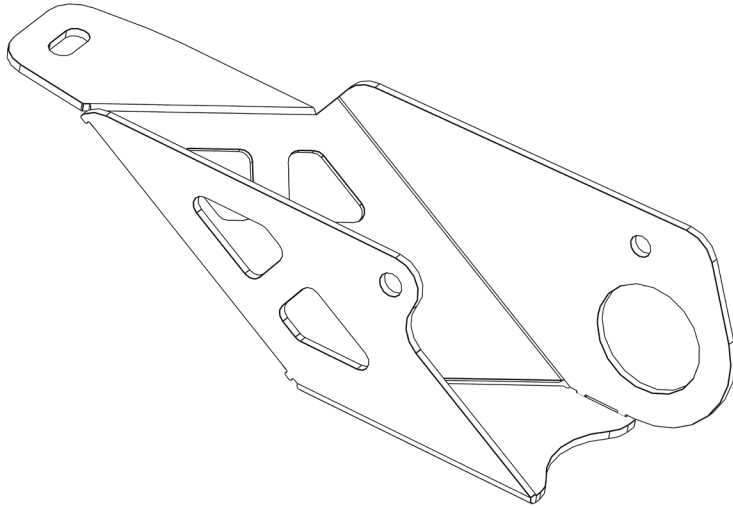

2x

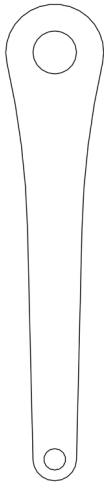

DISASSEMBLY

1. To start you will need to loosen and get the gas tank and skid out of the way, so that you are able to access the factory bracket that will need to be removed. How you go about this depends on what configuration of skid system you have, being a factory gas tank skid, no skid with fuel tank straps holding it up or even our JCR gas tank skid. Make sure to use either a jack or straps to support the back of the tank when doing this step. It will need to be loose enough to hang down and off to the side in order to access the (2) torx screws on the inside of the rear lower control arms.



DISASSEMBLY

2. With the rear section of the tank loose and out of the way, you will need a torx plus 25 socket and ratchet to remove the (2) torx screws from the control arm. Once the screws are removed, the cover piece should just pop off and you can then just discard that since it will not be put back in place.



3. Take the provided skid for the correct side of the vehicle you are working on (driver side shown) and slide the big circle cut out over the factory control arm bolt and then pivot it up in line with the factory threaded hole, as shown below. The factory threaded hole will only be on the driver side of the vehicle. When installing on the passenger side of the vehicle, you will need to center punch the slot and drill a 7/16" hole into the frame. Once the hole is drilled you will install using the provided 1/2" self threading bolt. Once aligned on the driver side, take the provided M12 bolt and hand thread it into the hole to hold the skid in place.

ASSEMBLY



- 4.** If you are also running any other JCR products on your Bronco, make sure to have them oriented correctly since multiple products thread into that same hole. Make sure the sliders are on the bottom, tight to the frame, then the lower control arm bracket on top, followed by the gas tank skid plate bracket on the top.

ASSEMBLY

5. With the skid now held in place, take the provided 3/8" hex bolt, washer and flange nut and assemble in the orientation shown below. You will need reach up and behind the flange for the control arm and slide the nut over the hole to line up with the bolt.

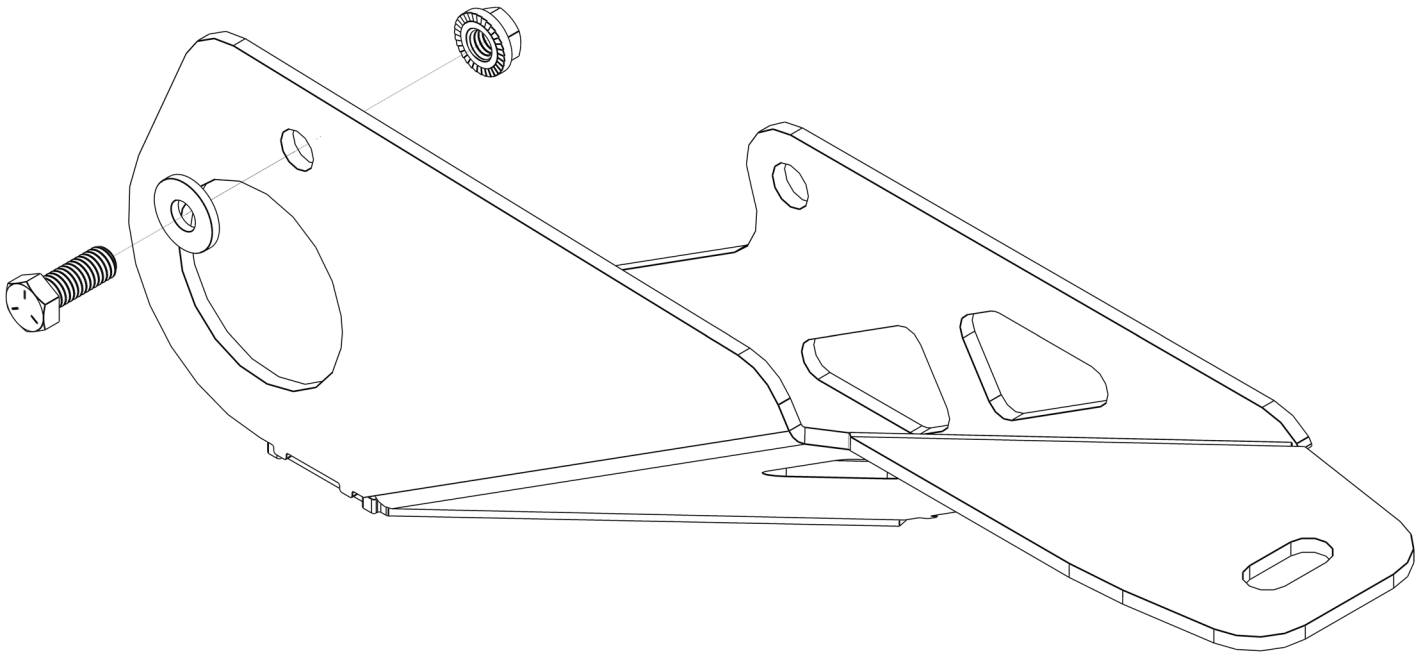

ASSEMBLY

6. The final step you will need to move to the inside of the vehicle, between the frame and the tank. Take the provided nut tab and slide it under the control arm and behind the skid until it is lined up with the hole on the back side of the skid and thread in the provided 3/8" bolt and washer, and tighten down. This may take some tweaking and maneuvering of the nut tab to get it to line up correctly.

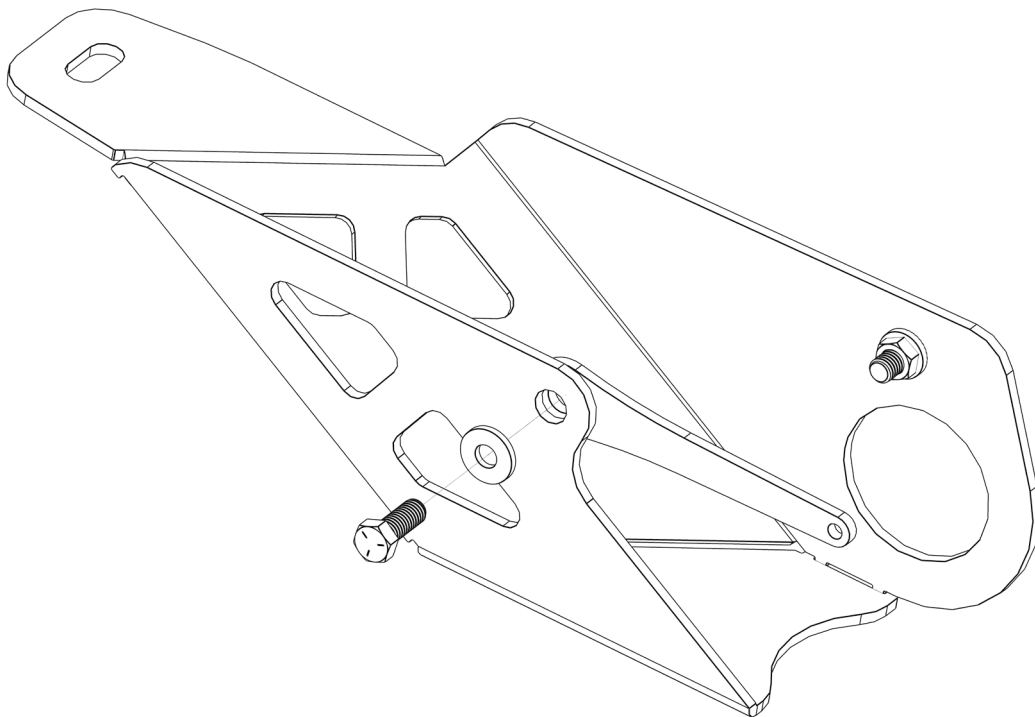

ASSEMBLY

6. Make sure that all of your hardware is fully tightend and you have repeated these steps on each side of the vehicle to complete your install. Enjoy your new skids!

