



TABLE OF CONTENTS

4 DOOR 6TH GEN BRONCO REAR WINDOW MOLLE PANEL.....	2
2 DOOR 6TH GEN BRONCO REAR WINDOW MOLLE PANEL.....	7



4 DOOR 6TH GEN BRONCO REAR WINDOW MOLLE PANEL

INSTALL INSTRUCTIONS

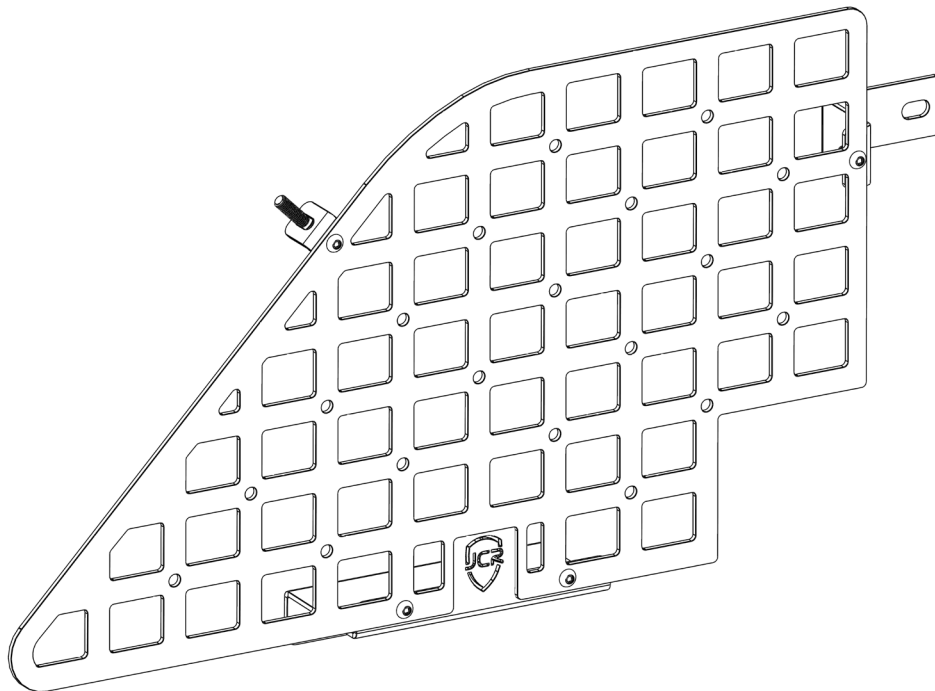

Please read the mounting instructions below carefully before attempting to install.

Be sure to check out the install video on the product page, if available.

Thank you for purchasing from JcR Offroad! Checkout our website, www.jcroffroad.com for other great off-road products. Be sure to rate and review our product online. If you have any questions or are missing parts, please don't hesitate to call us at 269-353-1184!

INCLUDED HARDWARE

4x

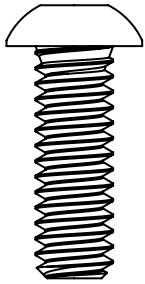

1/4"-20 X 3/4"
Button Head

3x

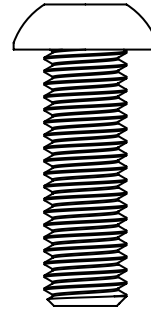

25mm M8
Button Head

4x

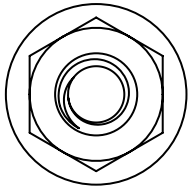

1/4"-20
Serr. Flange Nut

INCLUDED PARTS

1x

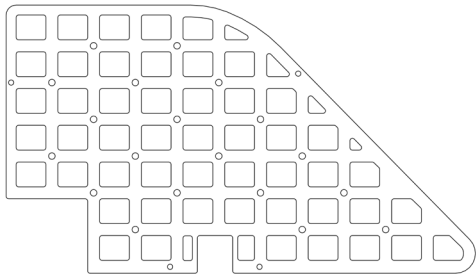

1x

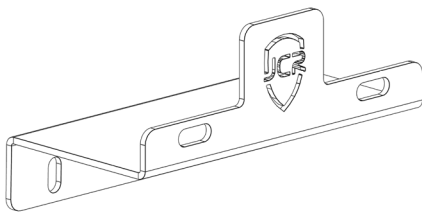

HARD TOP ONLY

1x

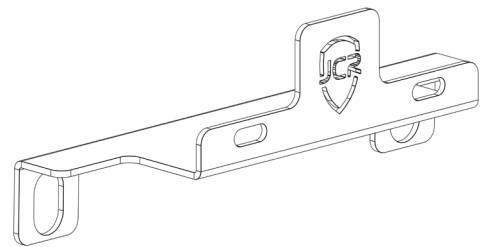

SOFT TOP ONLY

1x

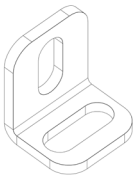

1x

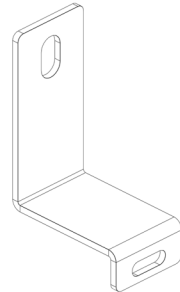

ASSEMBLY

- 1** Start by popping the small plastic panel beneath the rear window out of place. Then, detach the nearest seat belt from its mounting point. To do this, pop the plastic cover off of it by pulling out on the top edge of it. Doing this will expose a bolt. Unscrew that bolt using a T50 socket and then you will need to thread the push nut off of the back of the bolt in order to get the spacer off. Set everything to the side for now, making sure not to lose any hardware.
- 2** Next, loosely attach the mounts to the vehicle. The rear mount attaches directly to the rear roll bar using an M8 bolt through a factory threaded hole as shown below on the left. The lower mounts are slightly different depending on whether you have a soft top or hard top. The hard top mount attaches behind the plastic panel you pulled off using two more M8 bolts in threaded factory holes as shown below on the right. The soft top mount needs to be installed into the top two soft top mounting holes using the factory hardware. These holes are located behind the plastic panel as well you removed as well. The front mount gets sandwiched between the seatbelt retainer and the spacer you removed. Place the wider slot onto the bolt behind the retainer, and then reinstall the spacer and push nut. Then, reinstall the whole thing back into the seat belt's factory mount. Make sure that all the mounting faces for the MOLLE panel are pointing out, away from the window.

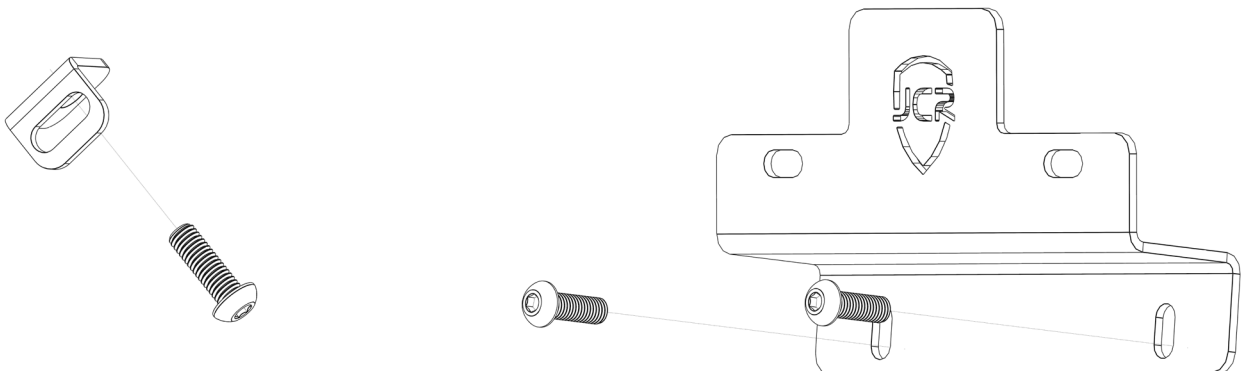

ASSEMBLY

- 3** Next, loosely mount the panel to the mounts using the four 1/4"-20 X 3/4" button head bolts and 1/4"-20 serr. flange nuts. Once all bolts are loosely in place, adjust the position of the panel in the window until you are happy with it. Then, tighten everything into place, starting with the bolts holding the upper two mounts to the frame, followed by the lower mount. Finally, tighten the bolts holding the panel to the mounts. When tightening the seatbelt back into place, torque it to 40 ft lbs.

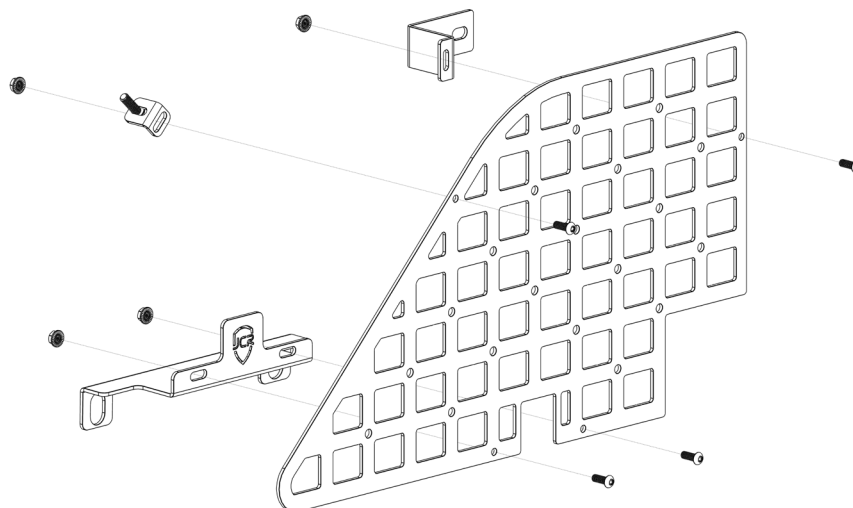
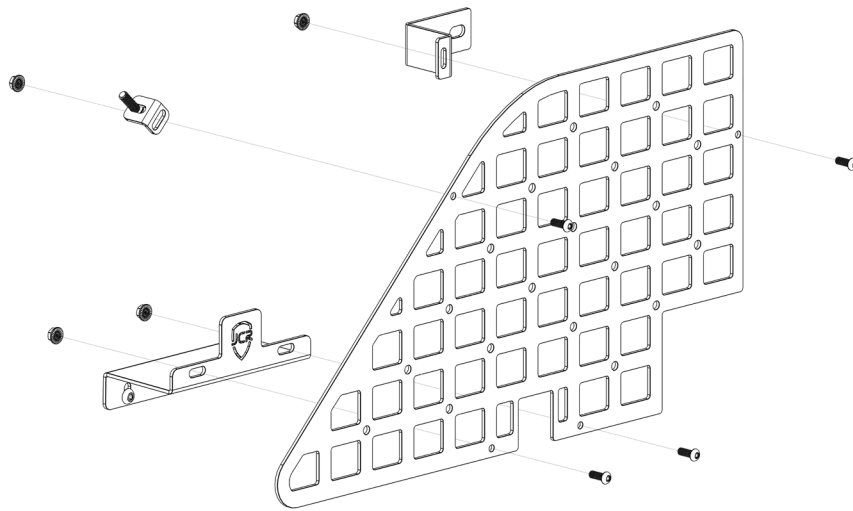



2 DOOR 6TH GEN BRONCO REAR WINDOW MOLLE PANEL

INSTALL INSTRUCTIONS

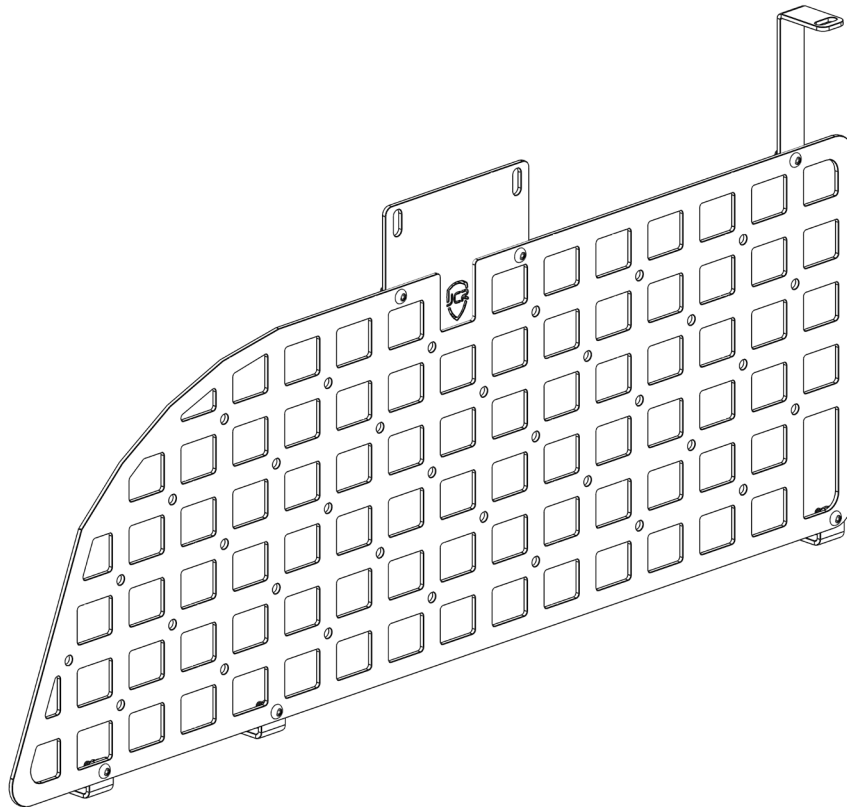

Please read the mounting instructions below carefully before attempting to install.

Be sure to check out the install video on the product page, if available.

Thank you for purchasing from JcROffroad! Checkout our website, www.jcroffroad.com for other great off-road products. Be sure to rate and review our product online. If you have any questions or are missing parts, please don't hesitate to call us at 269-353-1184!

INCLUDED HARDWARE

6x

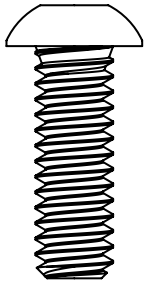

1/4"-20 X 3/4"
Button Head

3x

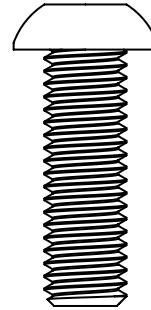

25mm M8
Button Head

6x

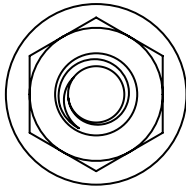

1/4"-20
Serr. Flange Nut

INCLUDED PARTS

1x

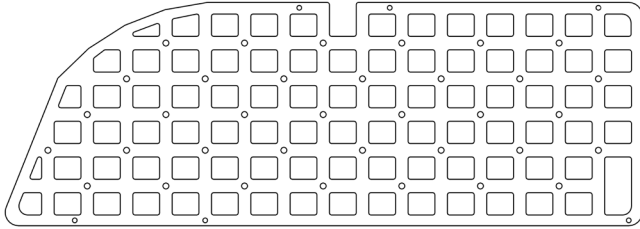

1x

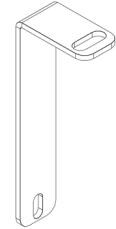

1x

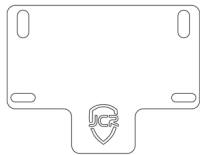

3x

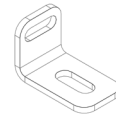

ASSEMBLY

- 1 Start by loosely installing all the mounts to the inside of the rear window. The three small L shaped brackets get installed into the hardtop mounting points on the bottom of the window using the factory hardware. The longer leg of the bracket is the one that gets mounted to the vehicle. The shorter leg should be pointing up and positioned towards the inside of the mounting bolts. The flat bracket installs into the middle of the outside face of the roll cage through two factory holes using the provided M8 button heads. The larger L shaped bracket mounts to the top of the face of the roll cage, in front of the flat bracket.

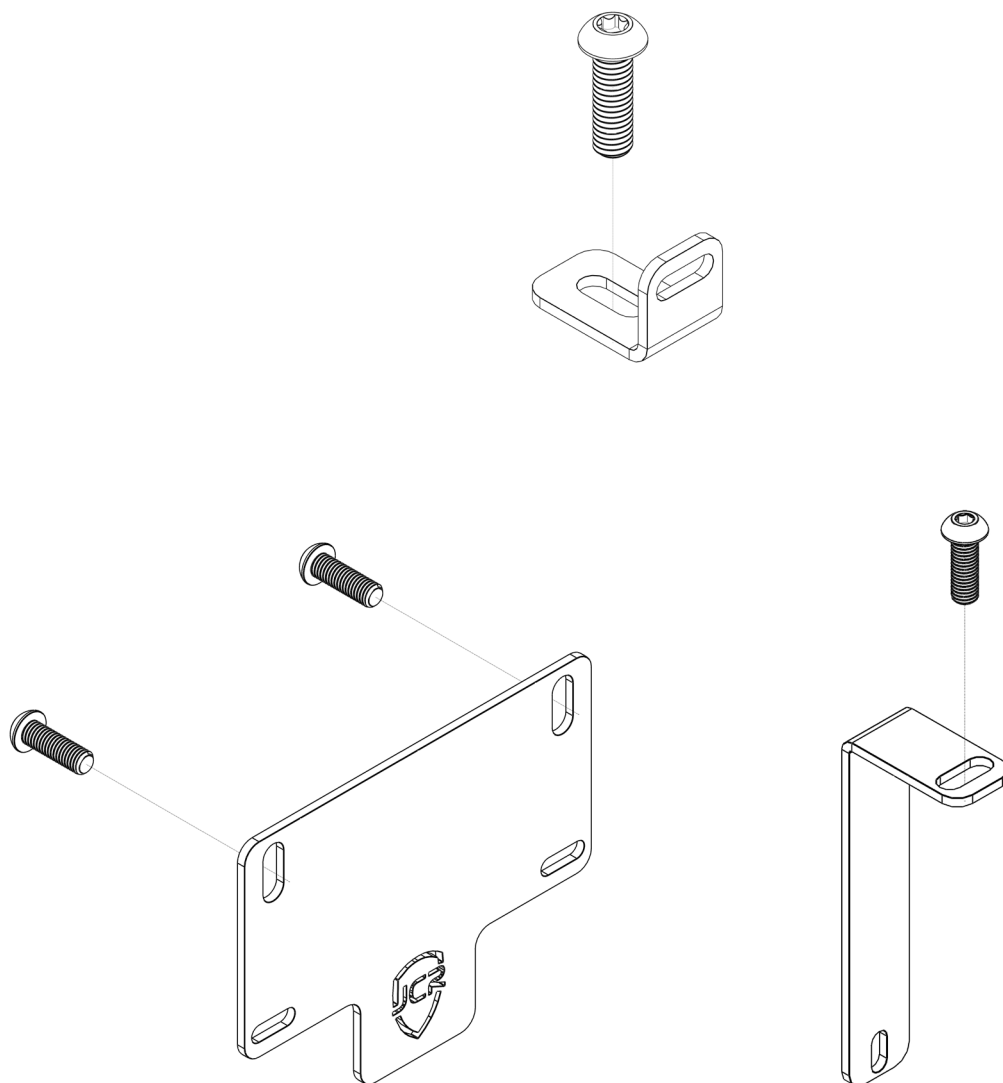

ASSEMBLY

- 2** Once all the mounts are loosely installed, mount the MOLLE panel to them using the 1/4"-20 X 3/4" button head bolts and 1/4"-20 serr. flange nuts. Once the panel is loosely installed, tighten the mounts into place. Then, adjust the position of the panel until it is where you want it and then tighten it into place.

