

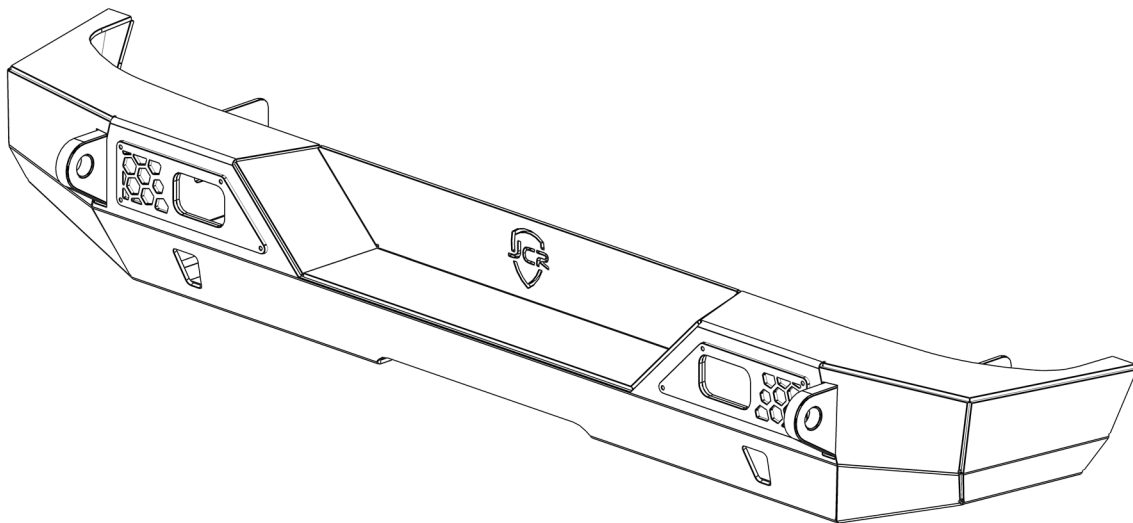

JEEP WRANGLER JK REAR CRUSADER BUMPER

INSTALL INSTRUCTIONS



**Please read the mounting instructions below carefully before attempting to install.
Check out the install video on the product page for factory rack disassembly.**

Thank you for purchasing from JcRoffroad! Checkout our website, www.jcroffroad.com for other great off-road products. Be sure to rate and review our product online. If you have any questions or are missing parts, please don't hesitate to call us at 269-353-1184!

INCLUDED HARDWARE

INCLUDED BOLT PACK(S) 045-0027

4x

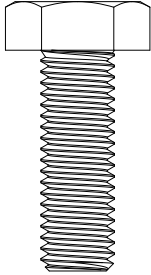

10MM Hex Head Bolt

4x

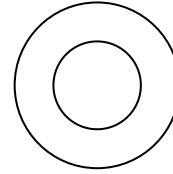

3/8" USS Flat Washer

6x

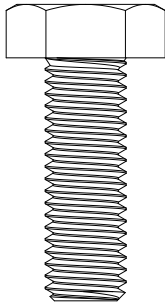

1/2"-13 x 1-1/2" Hex Cap

10x

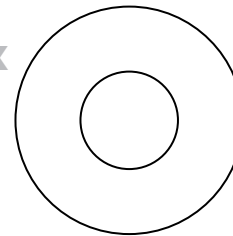

7/16" USS Flat Washer

2x

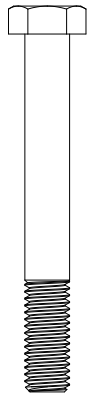

1/2"-13 x 4-1/2" Hex Head Bolt

2x

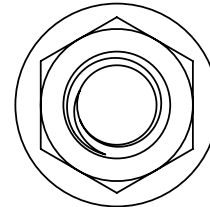

1/2"-13 Medium Sr. Locknut

4x

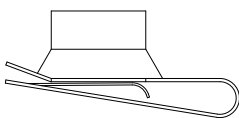

5/16"-18 U-Nut

4x

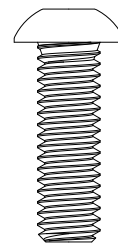

5/16"-18 x 1" Button Head

8x

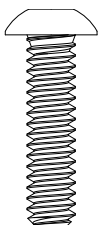

18-8 10-24 x 3/4" Button Head

8x

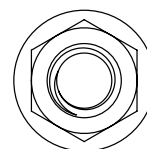

10-24 x 3/8" Flange Locknut

Note: Some Victory 4x4/JCR Offroad/SquatchProof products share hardware kits. Any extra hardware you may receive that is not listed above can be reused or discarded.

INCLUDED PARTS

1x

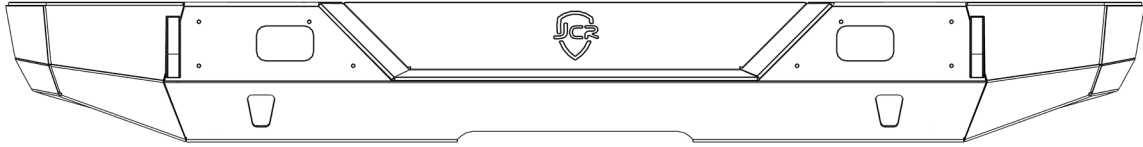

Crusader Rear Bumper

2x

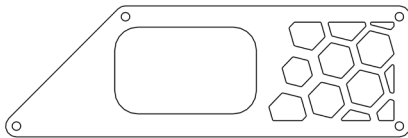

Accent Bezels

1L/1R

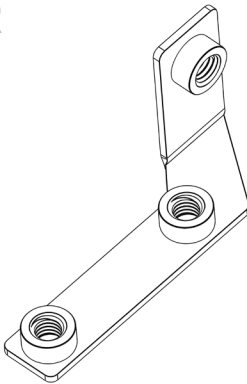

Nut Strips

ASSEMBLY

- 1.** Start by removing the factory rear bumper retaining clips using a 16mm socket or wrench, as shown below.



- 2.** Using the same wrench, remove the outer support bolts on the bumper.
- 3.** Now that all of the bolts are removed, the bumper can be removed from the vehicle.

ASSEMBLY

4. With the bumper out of the way, you will now need to mark and drill a 9/16" hole in each side of the rear frame. There will already be an existing factory hole located on each side, you will need to measure 3" ahead of the existing hole and mark and drill out a hole on each side of the frame making (2) holes total. You can use the next step as a guide to where the holes will line up.
5. Now that the (2) new holes are drilled, take the (2) provided nut strips and align them with the factory holes in the frame and the new hole that was just drilled, as shown below. Do this on both sides.



ASSEMBLY

- 6.** At this time, install any lights you plan to run on the bumper. Be sure you can access any wiring after you install the bumper onto the vehicle. There will be cut outs and mounting locations in the bumper for the Baja Designs 2"x1" S2 or similar lights. This is also the time to install the (2) included bezel plates onto the face of the bumper around the light cut outs, using the (4) provided 10-24 button heads and flange nuts per side.
- 7.** With the help from a friend or a jack, lift and place the bumper into place on the frame. Use the (3) of the provided shorter 1/2" hex heads with a washer on each side to install through the side of the bumper into the nut strip to hold it in place. There also will be (2) M10 bolts with washers used on each side to be installed into the side of the frame. Install as shown in the orientation below.

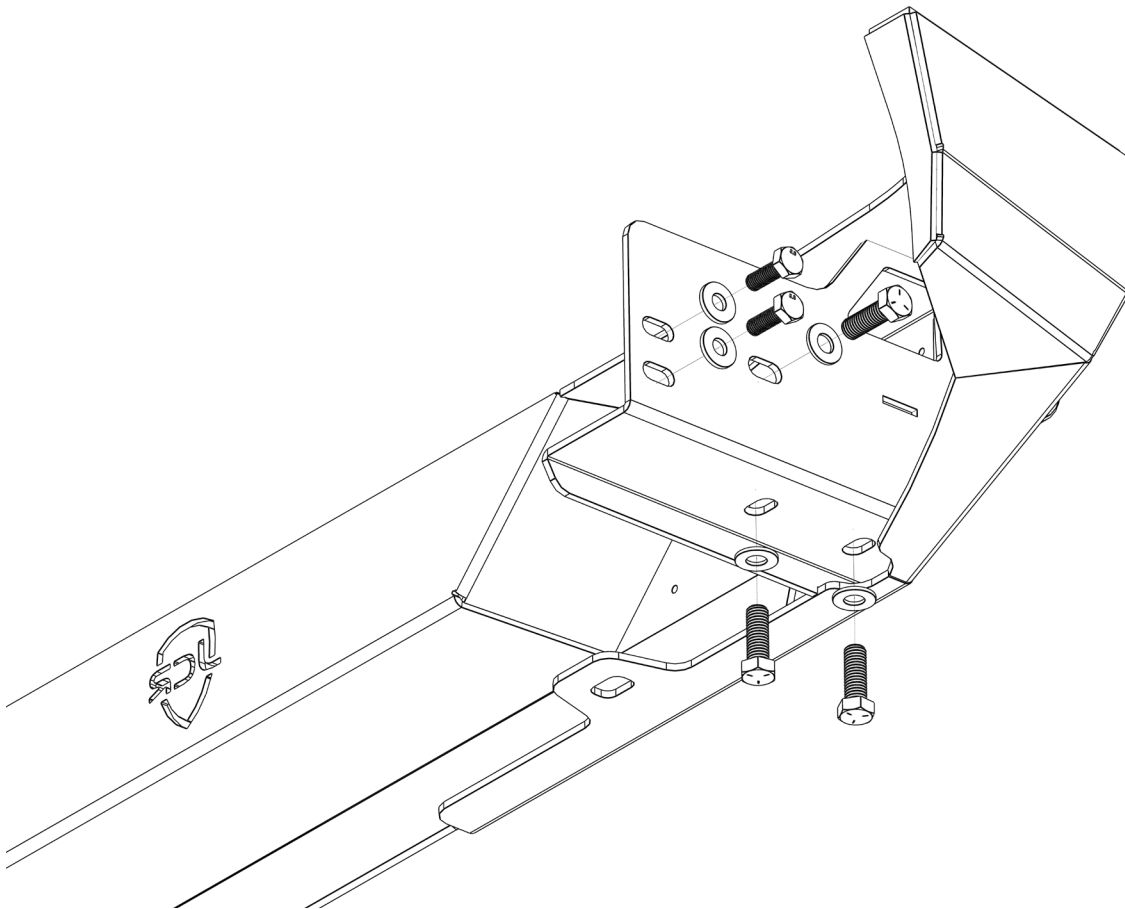

ASSEMBLY

8. With the bumper in place, take the (2) longer provided 1/2" hex head bolts and install them up through the cross member using the middle cut outs in the bumper, with a washers and nylock nuts on top.

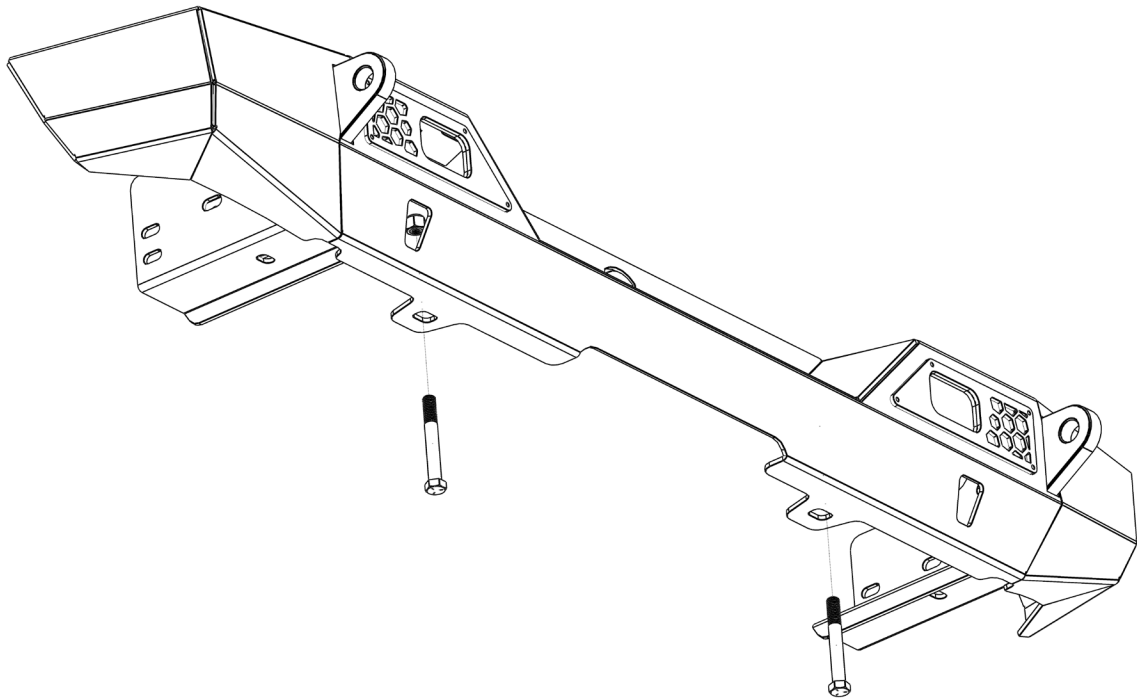

ASSEMBLY

9. Now that the bumper is on the vehicle with all of the hardware, make sure all of your hardware is tight and do any wiring that may need to be done to complete your install.



DRILL TEMPLATE

Note: Make sure scale is 1:1 before printing. Not all printers are the same, verify the template measurements before drilling your vehicle.

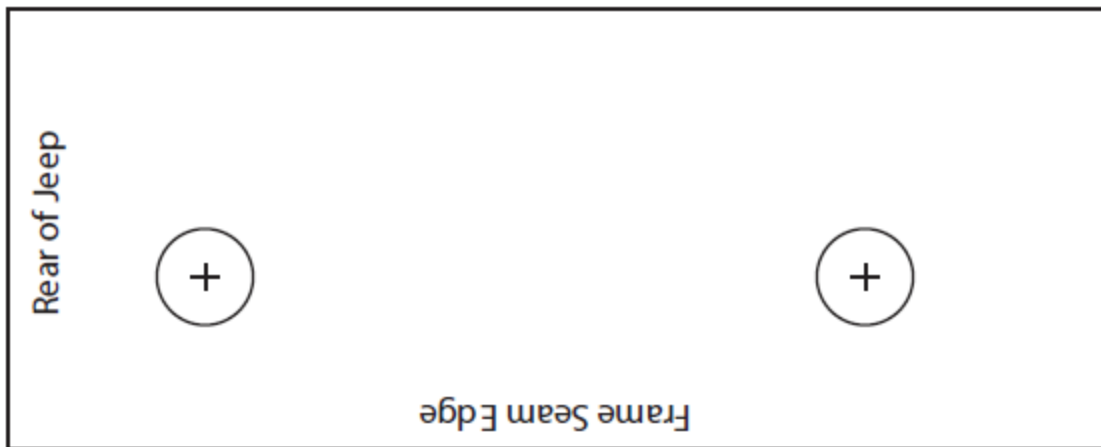
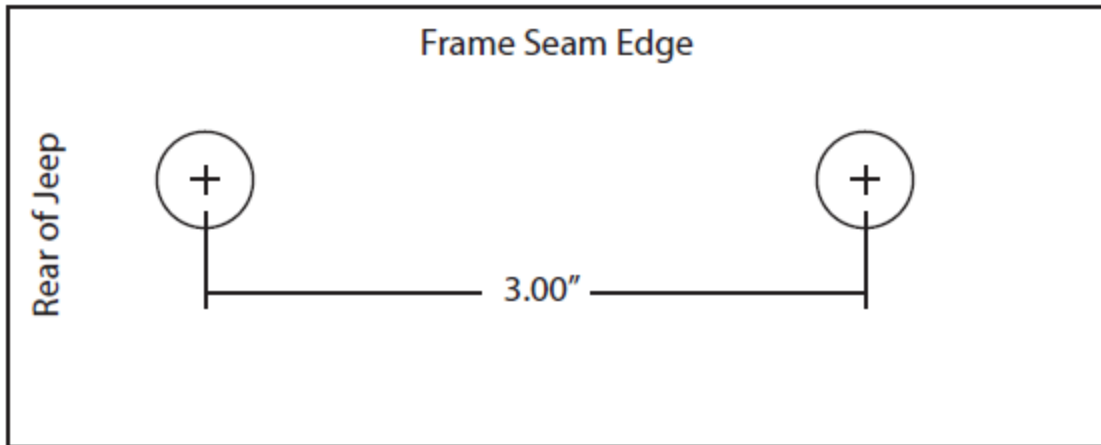

With some masking tape, tape the template to the frame horn to hold it in place. Using a center punch mark the holes. Drill out the holes to 9/16"