

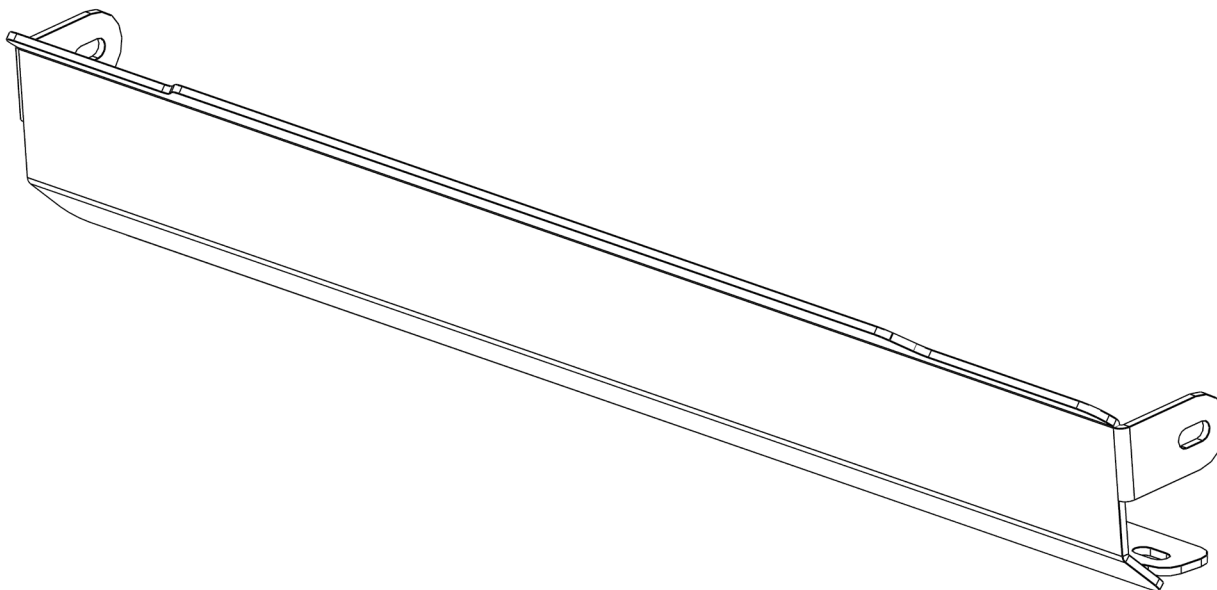

JEEP WRANGLER JK LOWER SKID

INSTALL INSTRUCTIONS



Please read the mounting instructions below carefully before attempting to install.

Check out the install video on the product page if available.

Thank you for purchasing from JcROffroad! Checkout our website, www.jcroffroad.com for other great off-road products. Be sure to rate and review our product online. If you have any questions or are missing parts, please don't hesitate to call us at 269-353-1184!

INCLUDED HARDWARE

4x

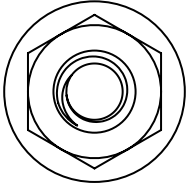

3/8"-16
Flange Nut

4x

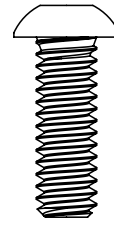

3/8"-16
Button Head

Note: Some Victory 4x4/JCR Offroad/SquatchProof products share hardware kits. Any extra hardware you may receive that is not listed above can be reused or discarded.

INCLUDED PARTS

1x

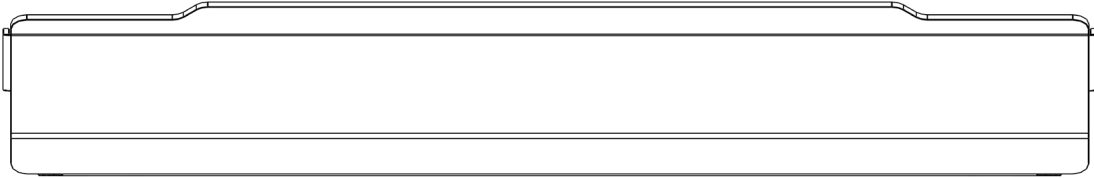

ASSEMBLY

1. To start, you may have to remove your factory plastic skid if your Jeep is equipped with one. If you do not have a skid or once it is out of the way, take the provided skid and 3/8" button heads and nuts and assemble to the frame as shown in the orientation below (view from behind) through the holes in the side of the skid. Once the bolts are started, hand thread the bolts in until they are hand tight.

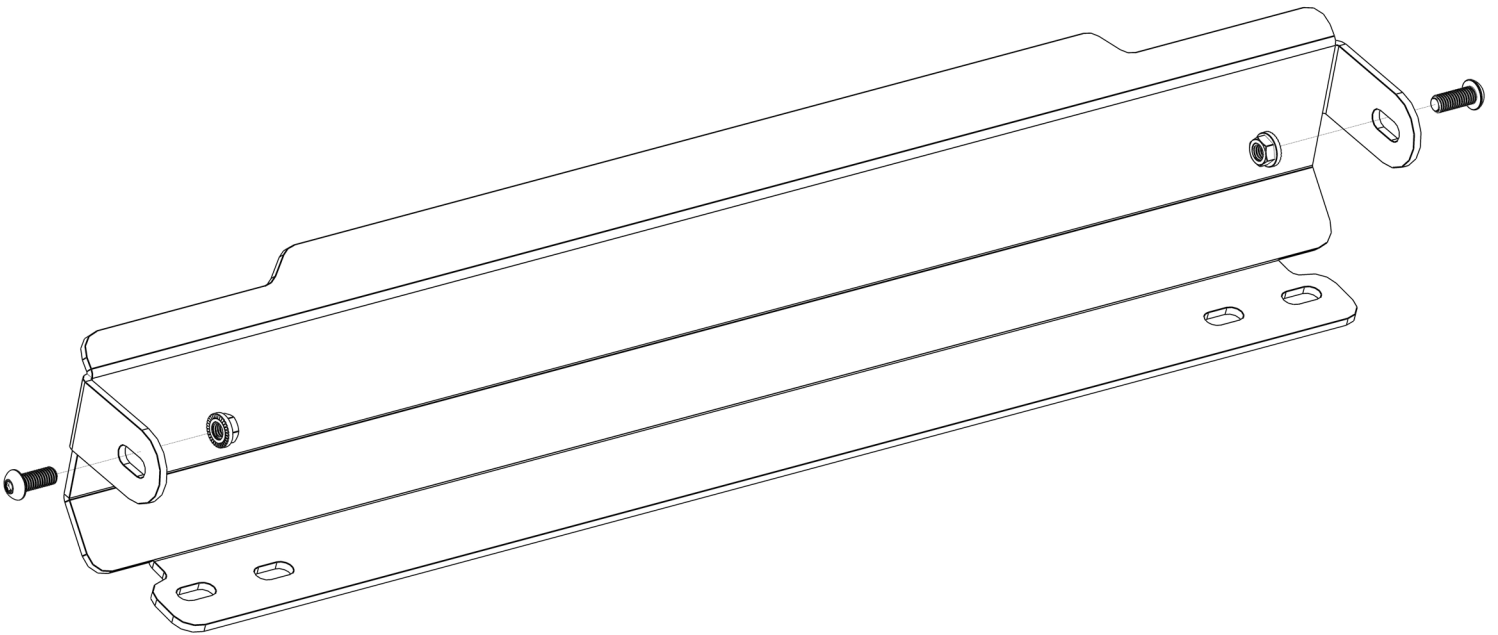

ASSEMBLY

2. Once the side bolts are hand tight, you will need to use the (2) other provided 3/8" button heads and nuts and assemble up through the bottom of the skid into the frame through the (2) slots, as shown in the orientation below. Depending on what year your Jeep is will depend on what set of slots you will need to use of them bottom of the skid. The inside slots that are shown are for a 12-18, and if you have a 07-11 then you will need to use the outside set of slots.

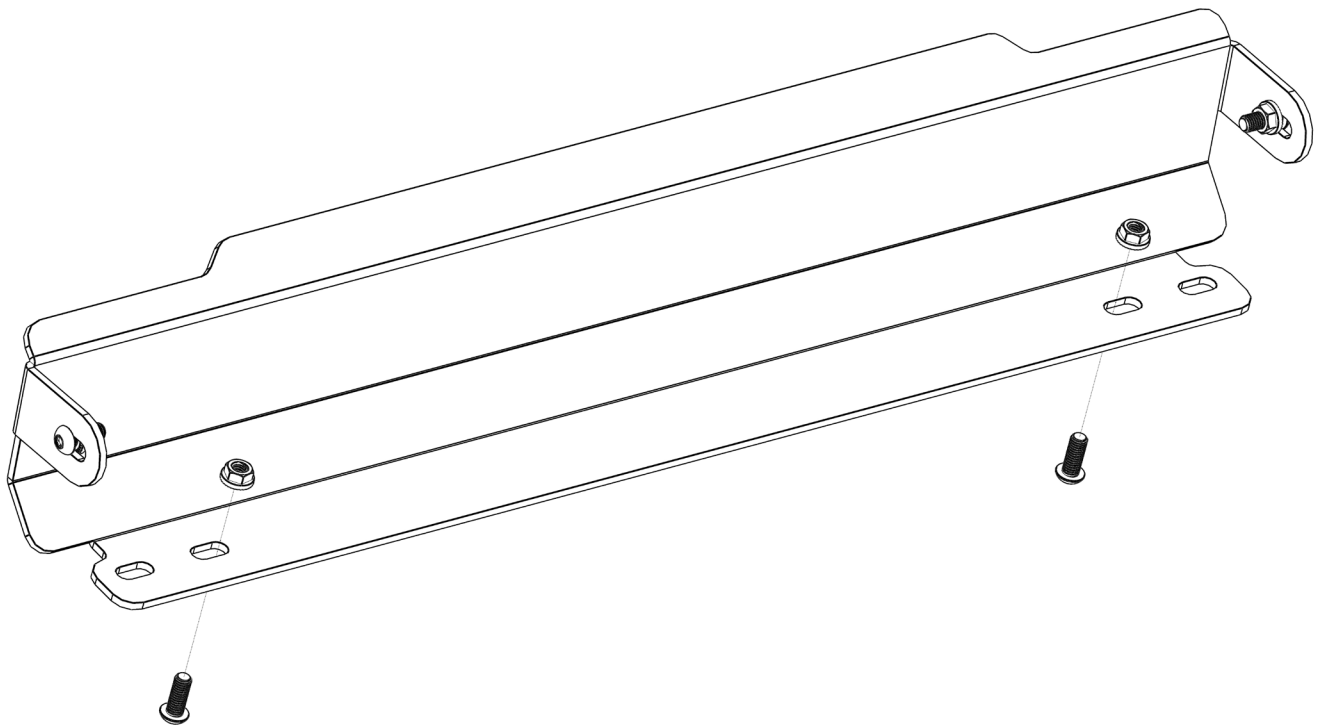

ASSEMBLY

3. Now that your skid is in place with all of the hardware started, you can now go around and fully tighten all of it down to finish your install.

