

JK TRAILGATE INSTALLATION INSTRUCTIONS

TOOLS NEEDED

- 13mm socket
- 14mm socket
- 3/16 allen wrench or socket
- 1/2" wrench
- Wire cutters/ strippers
- Wire crimpers
- Heat gun

HARDWARE

LED BRAKE LIGHT

- LED brake light
- Rubber grommet
- 2-PIN wire plug
- Wire connectors (2)

ROTOPAX MOUNTS

- 5/16" x 3/4"(4)
- RotoPax mounts (2)

LICENSE PLATE RELOCATION BRACKETS

- 3/8" Carriage Bolt
- 3/8" Flange Nut
- 5/16" Button Head Bolts (2)
- LED License Plate Light

**Please read the mounting instructions below
carefully before attempting to install.**

Thank you for purchasing your new Trailgate from JcROffroad!
Checkout our website, www.jcroffroad.com for other great off-road products. Be sure to rate and review our product online. If you have any questions or are missing parts, please don't hesitate to call us at 269-353-1184 x20!

It is always best to trial install before painting/finishing to ensure proper fit. If using a bed liner type product, you may need to use a drill or file to open holes or openings to the proper size, especially around the rubber grommet.

1 Pry open the tailgate vent panel to access the 3rd brake light wiring.



2 Next, unplug the wire connector. Push out the rubber grommet, and feed the plug and wiring out of the door.



- 3** Next, using a 13mm socket, remove the factory tire mount and remove the plastic vent located behind it. Clip about 8" off the tire carrier third brake light wiring loom.



- 4** Now, cut the wire off at the grommet, and pull it off and set aside for later. Using the provided connectors, strip and crimp the new 2" LED wire harness onto the section from the factory wiring. The black /yellow wire will connect to black, and the solid black wire will connect to the white wire. Once connected, heat the shrink tubing with a lighter or a heat gun.

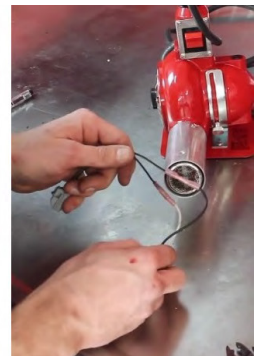
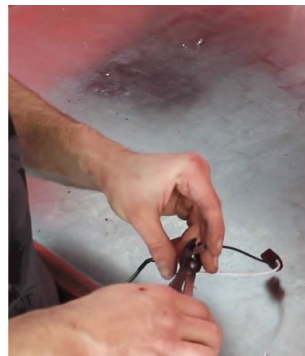
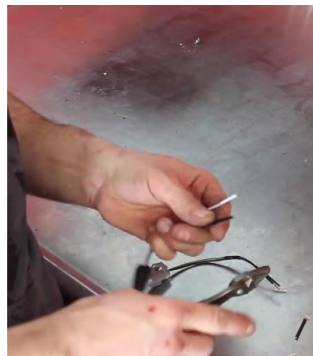

- 5** Next, remove the plug inside the tailgate from the retaining clip. Plug in the new harness and feed the wiring into the front access hole. Now reinstall inner tailgate vent panel.



- 6** Now, with the Trailgate plate facing down, install the round grommet so the inner lip is under the round metal ring. Now press in the LED light. With the light in place, flip the plate and loosely install the RotoPax mounts.

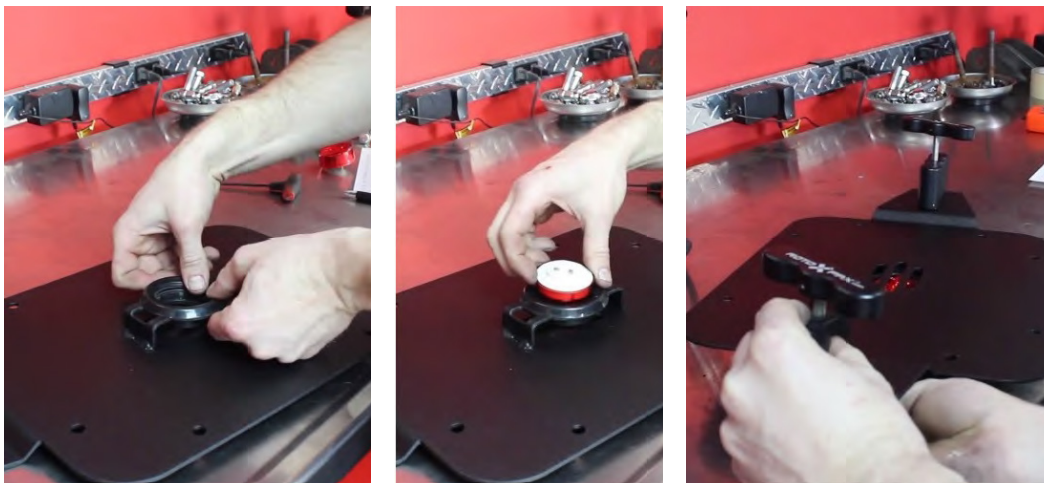

- 7** Plug in the new 3rd brake light and install the Trailgate plate using the 8mm button head bolts and tighten them down. Leave the bottom two bolts out. Once that's done, test fit the RotoPax containers and adjust the mounts, then tighten them down with a 1/2" wrench.



- 7** **OPTIONAL - If installing the license plate relocation bracket:** Using the bottom two bolts, install the lower bracket for the license plate relocation bracket. You can splice the license plate light to the running lights at this time. Install desired Rotopax. Then place the upper bracket into the tabbed area and install the 3/8" Carriage bolt. Tighten with a 14mm socket or wrench. Install License plate with the (2) 5/16" button head bolts.



- 8** Now it's time to head out with your newly installed Trailgate plate and enjoy the trails.

JKTGP - TRAILGATE PLATE - JK WRANGLER

Item Code Legend

EX: JKTGP-PC

-PC : Powdercoated

-BARE : Bare Metal



Additional Parts



Brake Light Kit



License Plate Relocation Bracket

Bolt Pack:

JKTGP-BP:

- (8) 8mm x 1.25 button head bolt
- 3/8 x 16 x 3/4 carriage bolt
- 3/8 x 16 flange nut
- (2) 5/16 x 18 x 1/2 button head bolt
- (2) 5/16 x 18 flange nut
- (2) 3mm x .5 x 16 button head bolt
- (2) 3mm x .5 hex nut

Boxes:

- 28 x 12 x 6

Packed By

Checked By

Revised: 02/16/17