

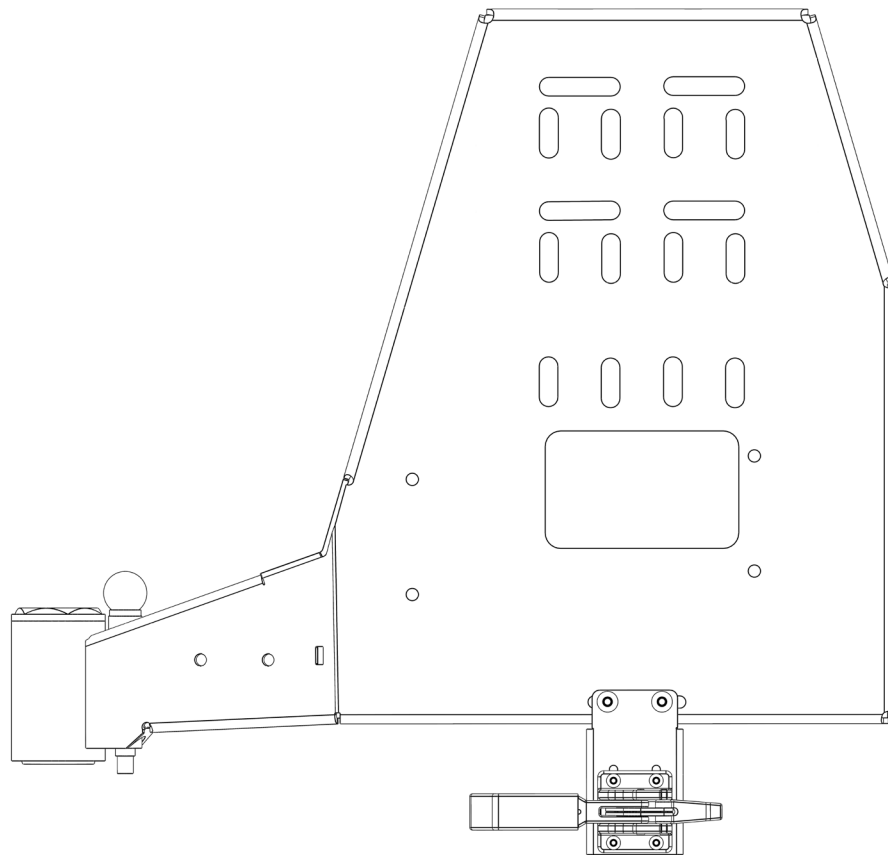

# UNIVERSAL ADVENTURE CARRIER

## INSTALL INSTRUCTIONS



**Please read the mounting instructions below carefully before attempting to install.**

**Be sure to check out the install video on the product page, if available.**

Thank you for purchasing from JcROffroad! Checkout our website, [www.jcroffroad.com](http://www.jcroffroad.com) for other great off-road products. Be sure to rate and review our product online. If you have any questions or are missing parts, please don't hesitate to call us at 269-353-1184!

# INCLUDED HARDWARE

3x



3/8"-16 x 1"  
Button Head

4x

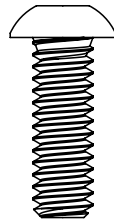

1/4"-20 X 3/4"  
Button Head

9x

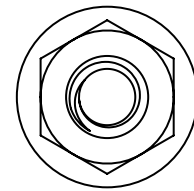

1/4"-20  
Serr. Flange Nut

2x

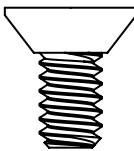

1/4"-20 X 1/2"  
Flat Head

1x

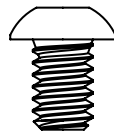

1/4"-20 X 3/8"  
Button Head

3x

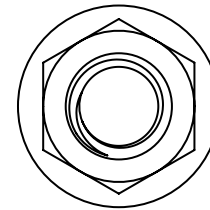

3/8"-16  
Serr. Flange Nut

2x

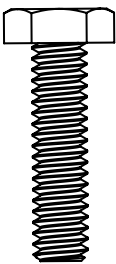

1/4"-20 X 1"  
Hex Head

1x

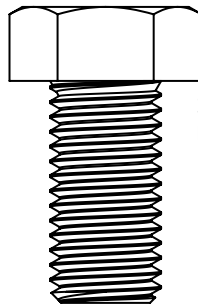

3/4"-10 X 1-1/2"  
Hex Head

1x

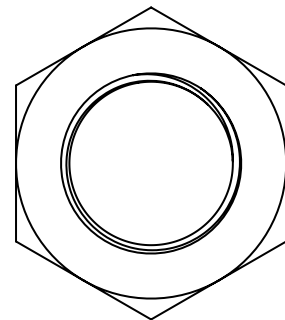

1"  
Nut

2x

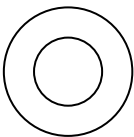

1/4"  
Washer

1x

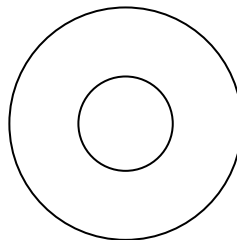

3/4"  
Washer

2x

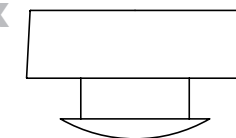

1/2" Rubber  
Push-in Bumper

1x

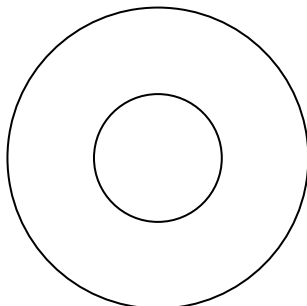

1"  
Washer

# INCLUDED PARTS

1x

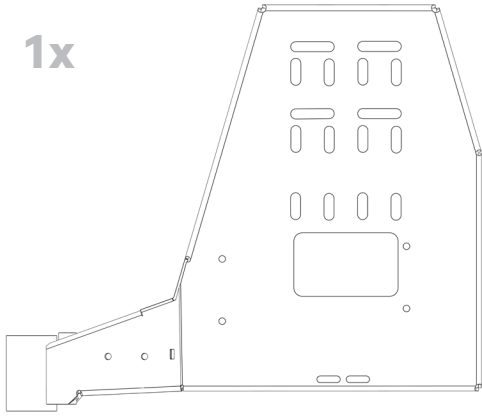

1x

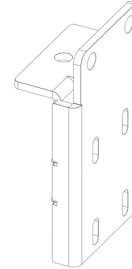

1x

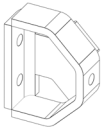

1x

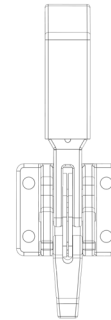

1x

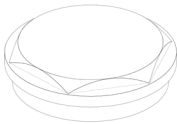

1x



1x

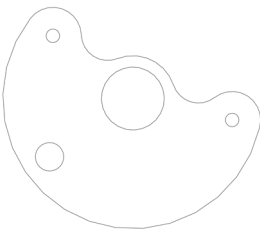

1x



1x

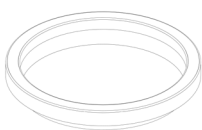

# INSTALLATION

- 1** Start by installing the pin track on whichever side of the bumper you are installing your carrier on. Make sure that when you line the holes up, the small bolt holes are counter sunk. Then use the 1/4"-20 x 1/2" flat head bolts and 1/4"-20 serr. flange nuts to secure it in place.

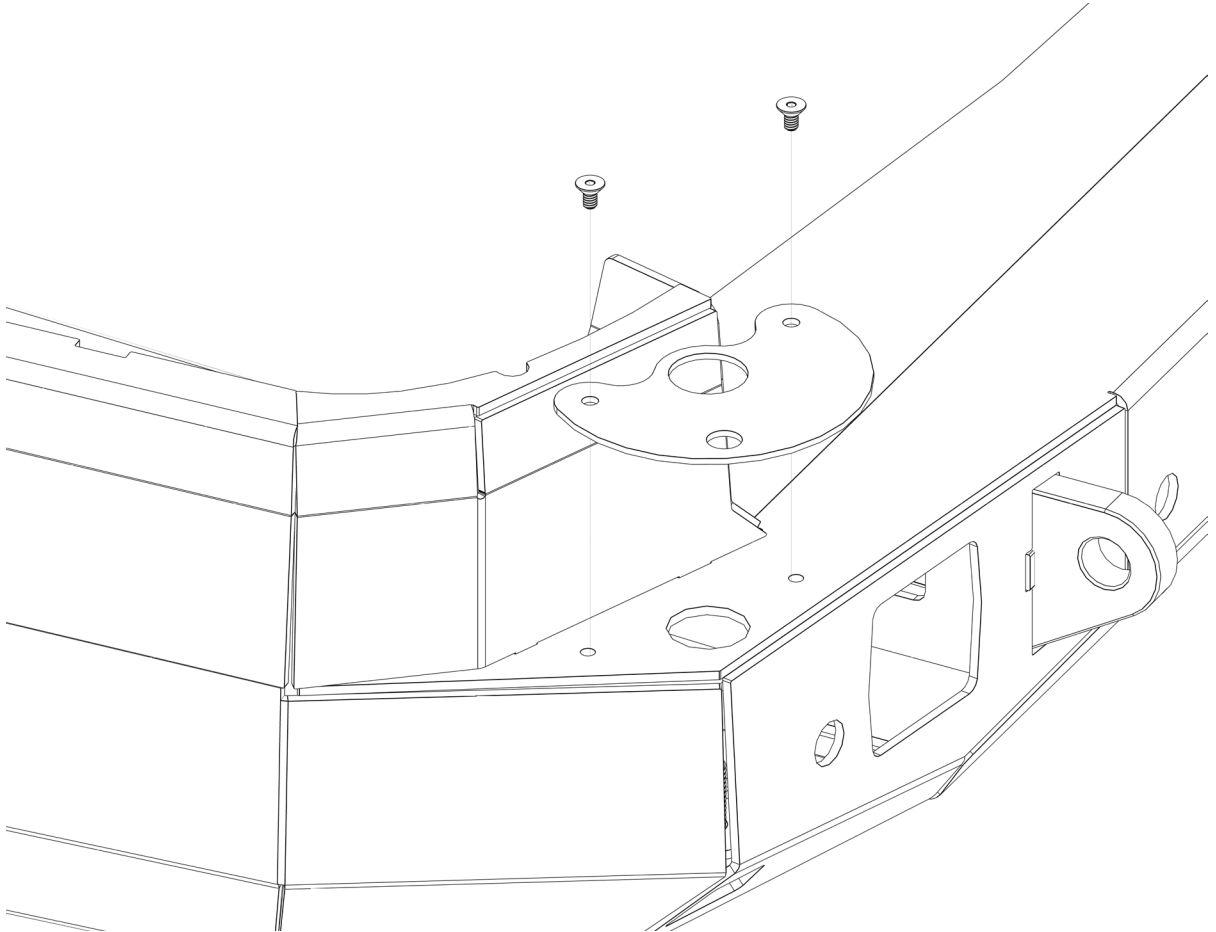

# INSTALLATION

- 2 Next, install the spindle into the bumper. Put the larger end of the spindle into the hole on the pin track. Then, use the 3/4" x 1-1/2" bolt with the 3/4" washer to secure it onto place. To do this you will need to insert the bolt and washer into the threaded hole in the bottom of the spindle by reaching around to the back of the bumper from the bottom.

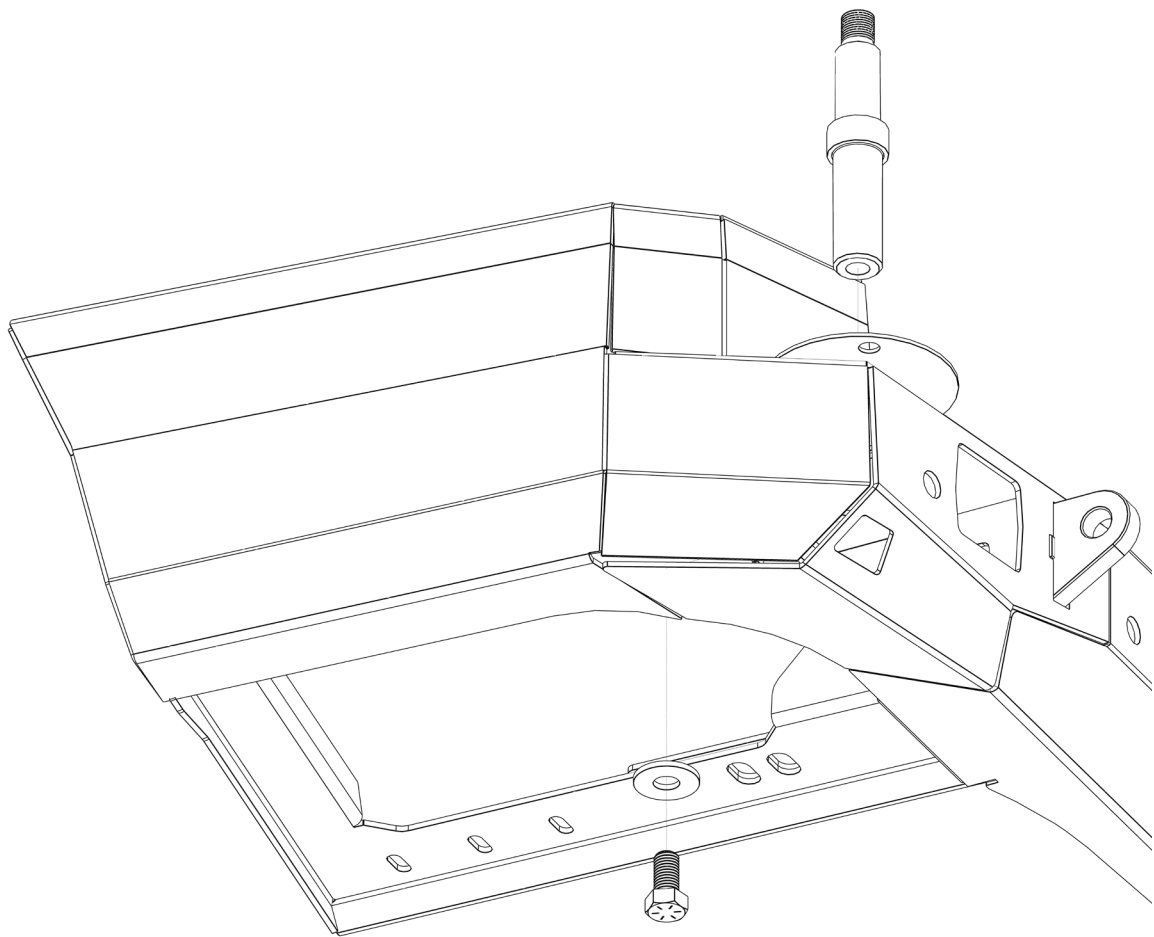

# INSTALLATION

- 3** Next, grease both bearings and the rubber seal. For more in-depth instructions on how to do so, watch the installation video. Then, flip your carrier door upside down, and insert 1 bearing and the rubber seal into the hub. Make sure that in this orientation, the smaller end of the bearing is facing down, and the softer rubber lip of the seal is facing up. You will then need to tap the seal into place using something such as a hammer and screwdriver.

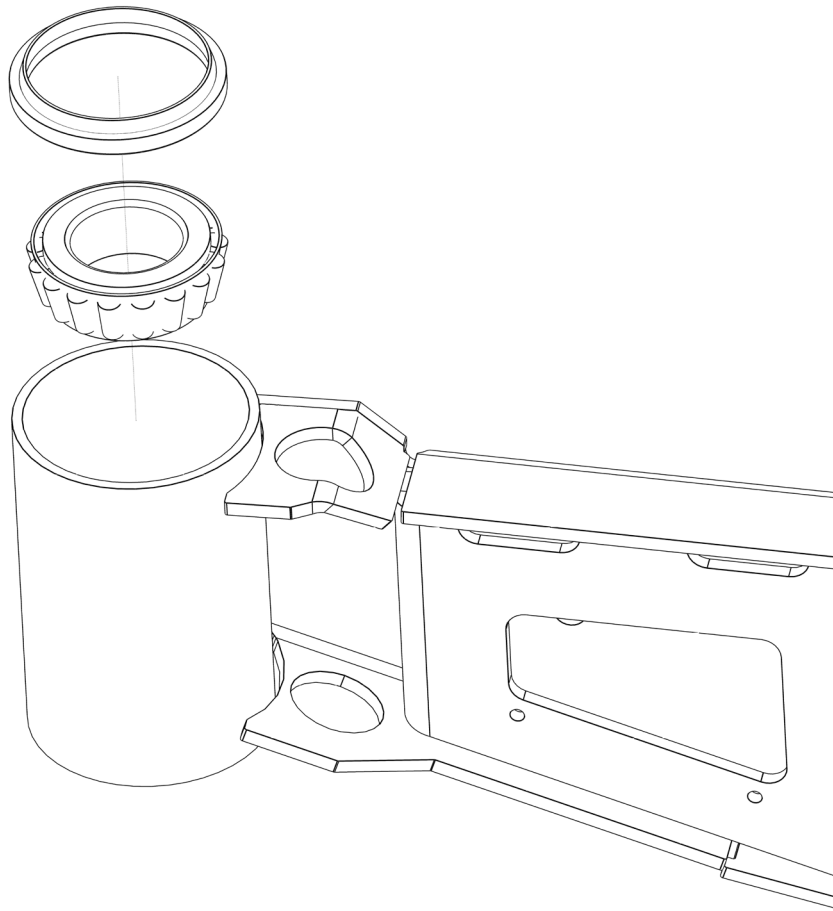

# INSTALLATION

- 4** Next, simply place the carrier onto the spindle.

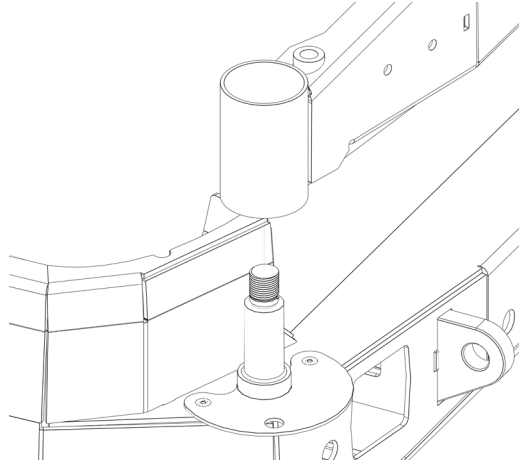

- 5** With that in place you can install the rest of the hardware into the hub. Start by putting the bearing into place, making sure that in this orientation the smaller end is again facing down. Then, place the 1" washer on top of the bearing. Next, thread the 1" nut onto the top of the spindle to secure the carrier into place. Make sure that you tighten it enough that there is no wiggle in the carrier, while also being careful to not put unnecessary strain on the bearings. You may need to adjust it once you mount gear. Finally, thread the spindle cap onto the top of the hub and tighten it using the provided wrench.

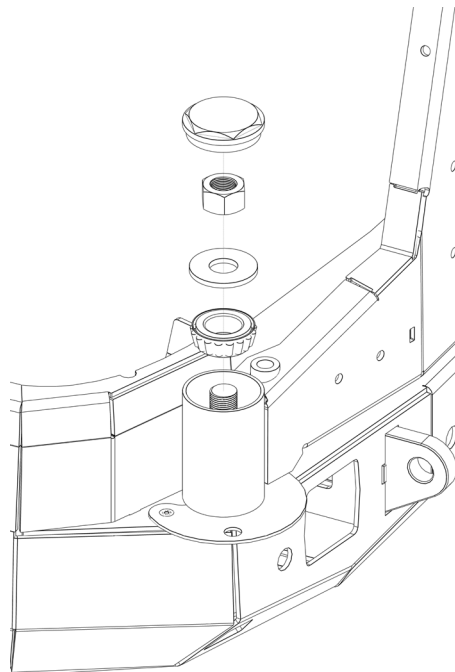

# INSTALLATION

- 6** Next, install the pull pin. To do this, grease the metal part of the pin and screw it into the small round threaded hole just to the side of the hub. To prevent the pull pin from sticking, we recommend greasing it frequently. You will want to choose which grease you use and how frequently you use it based on your climate and activities. Keep in mind: this is designed to lock the carrier in the open position, not to bring a swinging carrier to a stop.

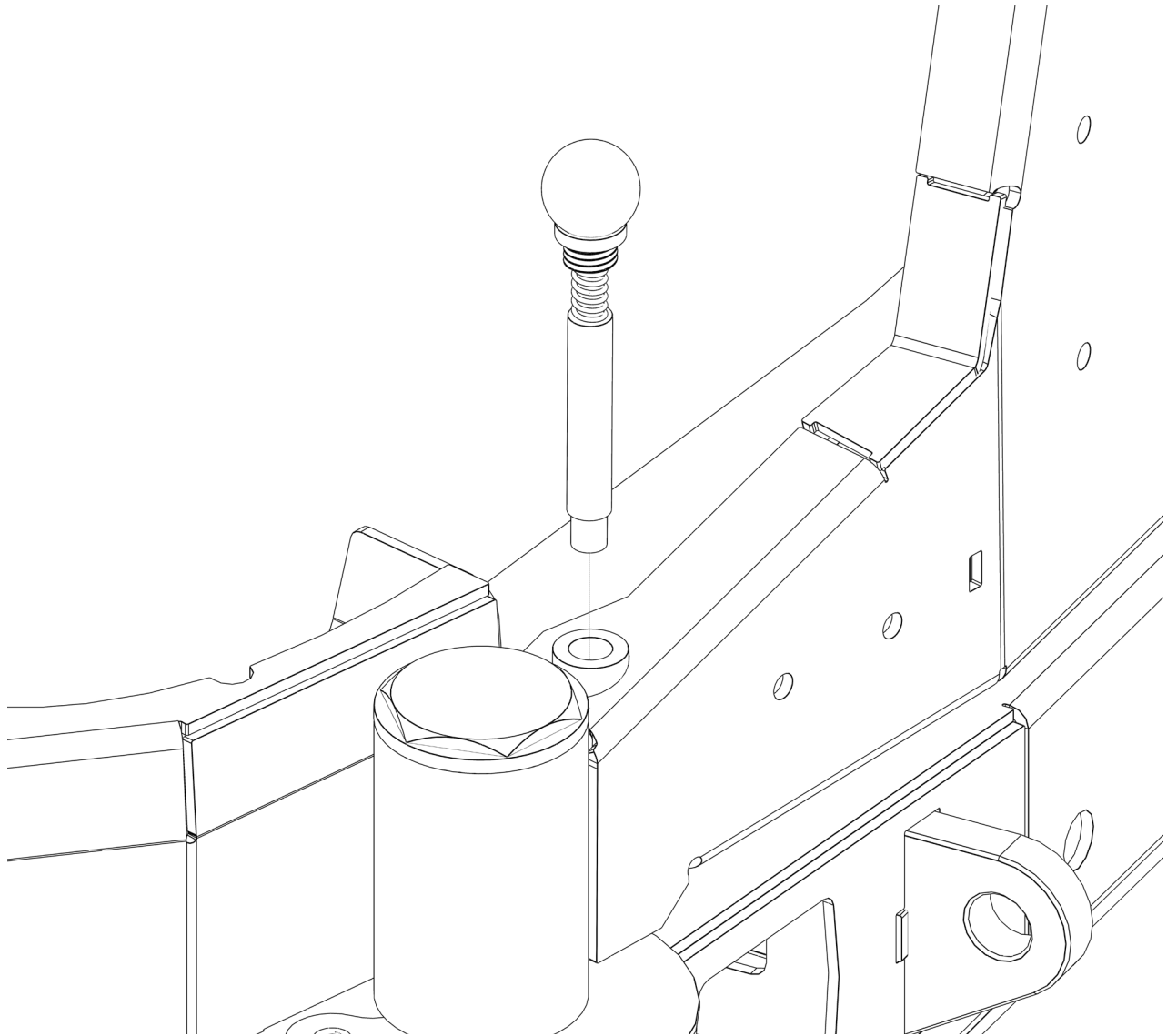



# INSTALLATION

- 7** With the carrier mounted you can install the latch. Start by mounting the small D shaped bracket onto the bumper using the 1/4"-20 x 1" hex head bolts, 1/4" washers and 1/4"-20 serr. flange nuts. The mounting slots for this bracket are located just below the carrier on the vertical face of the bumper. Make sure that the open end is facing towards the carrier. You can leave it loose for now in order to be able to adjust the position later. Next, put the 1/4"-20 x 3/8" into the hole on the front of the bracket and secure it with a 1/4"-20 serr. flange nut. This is just to give the latch something to hold on to.

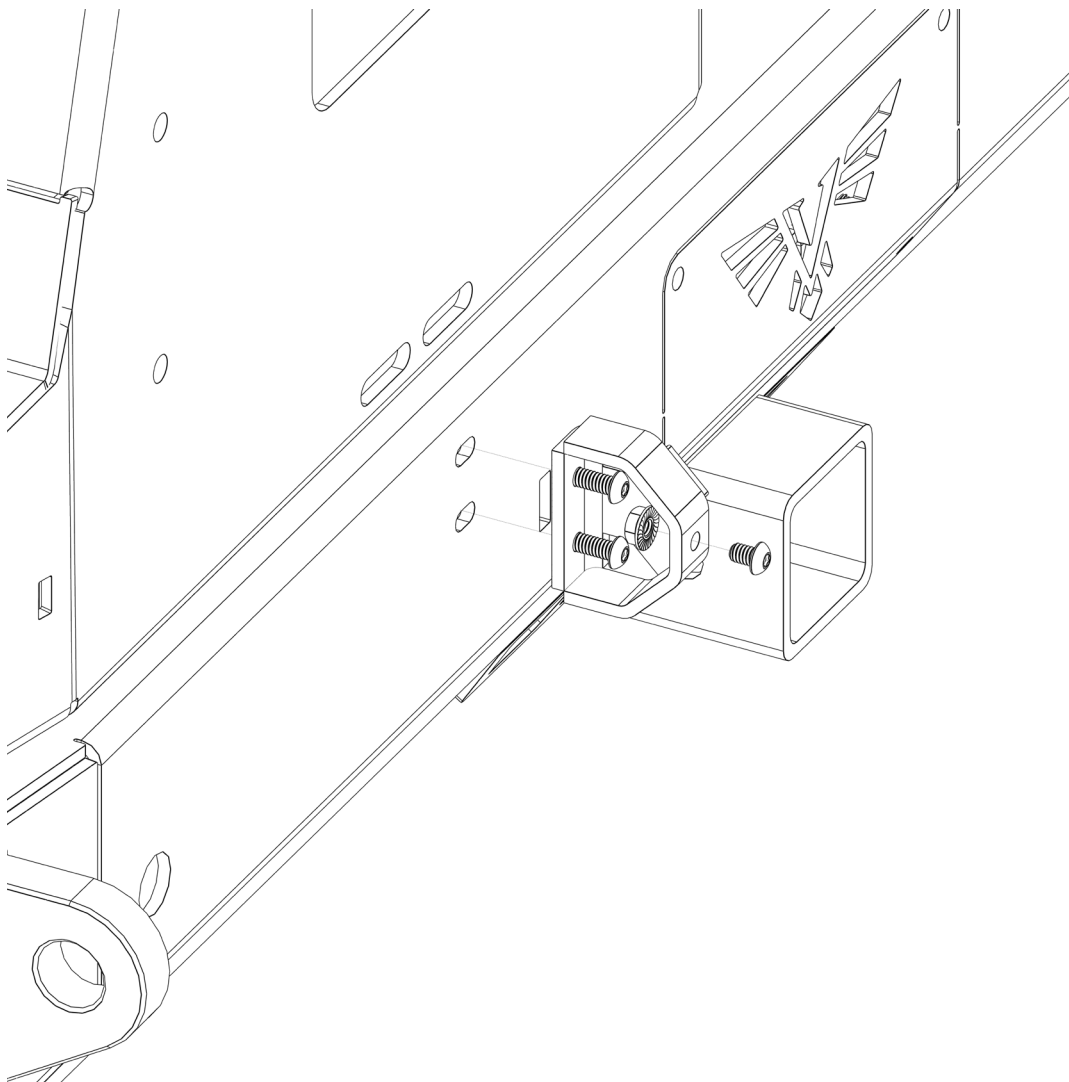

# INSTALLATION

- 8** Next, put the 2 rubber bumpers in the large holes in the latch mount and install it onto the carrier using the three 3/8"-16 x 1" bolts and 3/8"-16 serr. flange nuts. One bolt goes on the inside of the carrier through the bottom. These bolts can stay loose for now so they can be adjusted later.

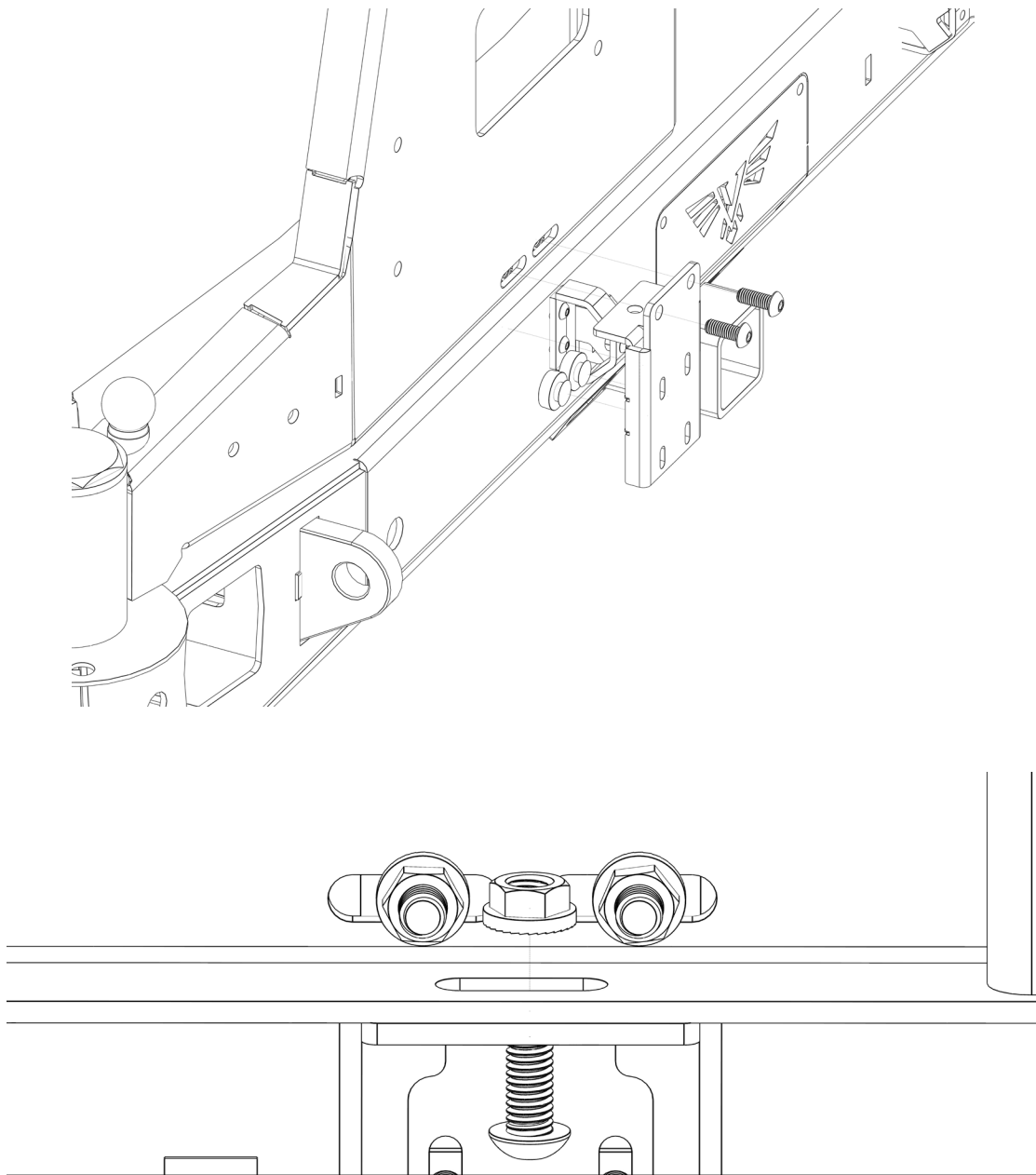

# INSTALLATION

- 9** Finally, install the latch onto the latch mount using the 1/4"-20 x 3/4" button head bolts and 1/4"-20 serr. flange nuts. At this point you can adjust the positioning of all the latch components so that the small nut on the inside of the D shaped bracket sits roughly centered on the face of the latch when latched. Once everything is in place, tighten all the loose bolts the rest of the way.

