

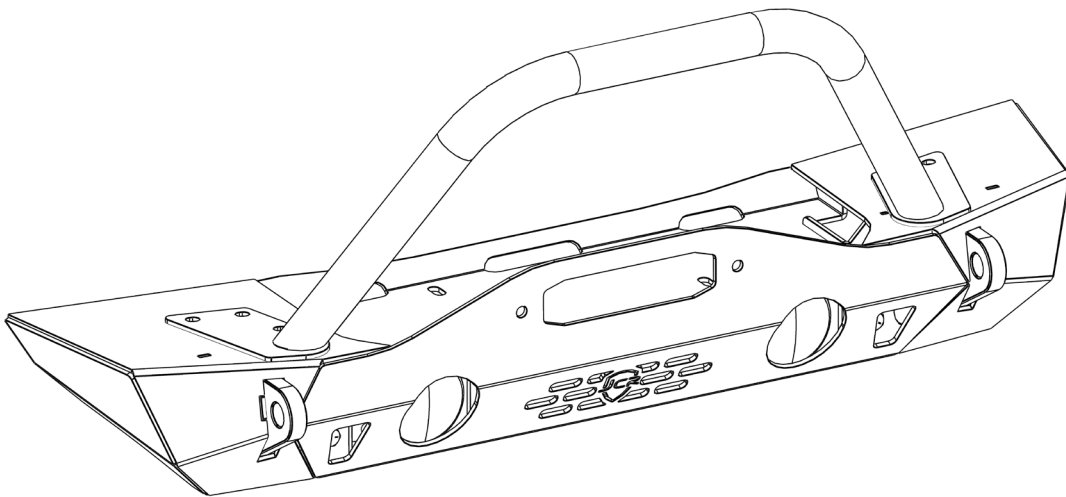

JEEP WRANGLER JK, JL/JT FRONT MAULER/ CRUSADER

INSTALL INSTRUCTIONS



Please read the mounting instructions below carefully before attempting to install.

Be sure to check out the install video on the product page, if available.

Thank you for purchasing from JcROffroad! Checkout our website, www.jcroffroad.com for other great off-road products. Be sure to rate and review our product online. If you have any questions or are missing parts, please don't hesitate to call us at 269-353-1184!

INCLUDED HARDWARE

INCLUDED BOLT PACK(S) 045-0007

8x

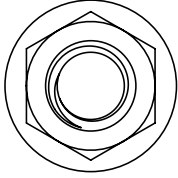

7/16"-14
Flange Nut

1x

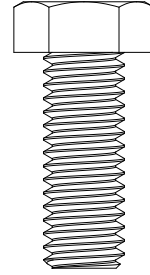

3/8"-16
Hex Cap

1x

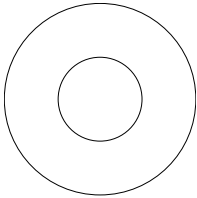

3/8" USS
Flat Washer

6x

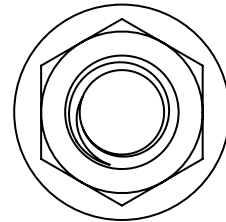

3/8"-16
Serr. Flange Nut

6x

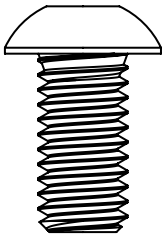

3/8"-16 X 3/4"
Button Head

8x

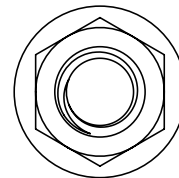

1/4"-20
Flange Locknut

Note: Some Victory 4x4/JCR Offroad/SquatchProof products share hardware kits. Any extra hardware you may receive that is not listed above can be reused or discarded.

INCLUDED PARTS

1x

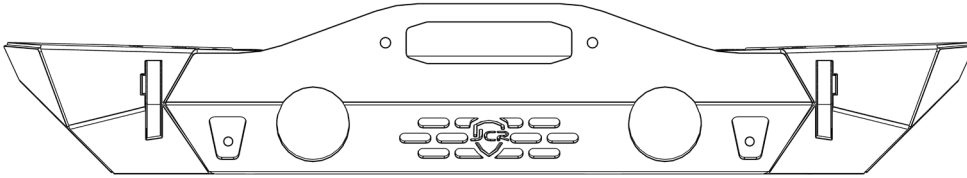

1x

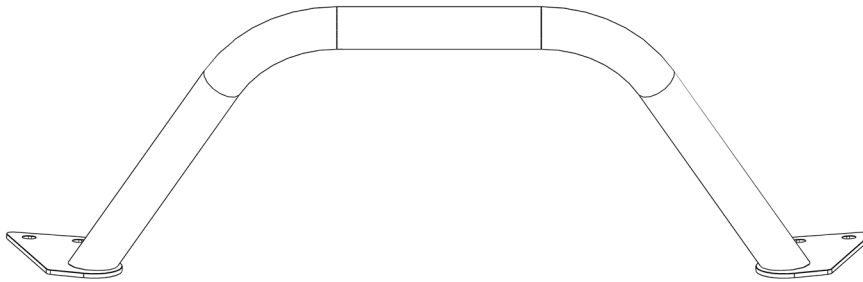

ASSEMBLY

- 1.** If you have a factory bumper and skid, start by removing them from the vehicle by removing the clips and bolts holding it down. Be sure to remove any factory fog lights from the bumper if you wish to keep them for the new bumper.
- 2.** If you chose to re-use your factory fog lights or have new after market ones, you will need to drill out the mounting holes bigger to be able to fit over the 1/4" studs on the bumper.
- 3.** Once you have the holes drilled out, take the provided 1/4" nuts and slide the fog lights over the studs, as shown below, and tighten the nuts onto the studs to hold them in place.

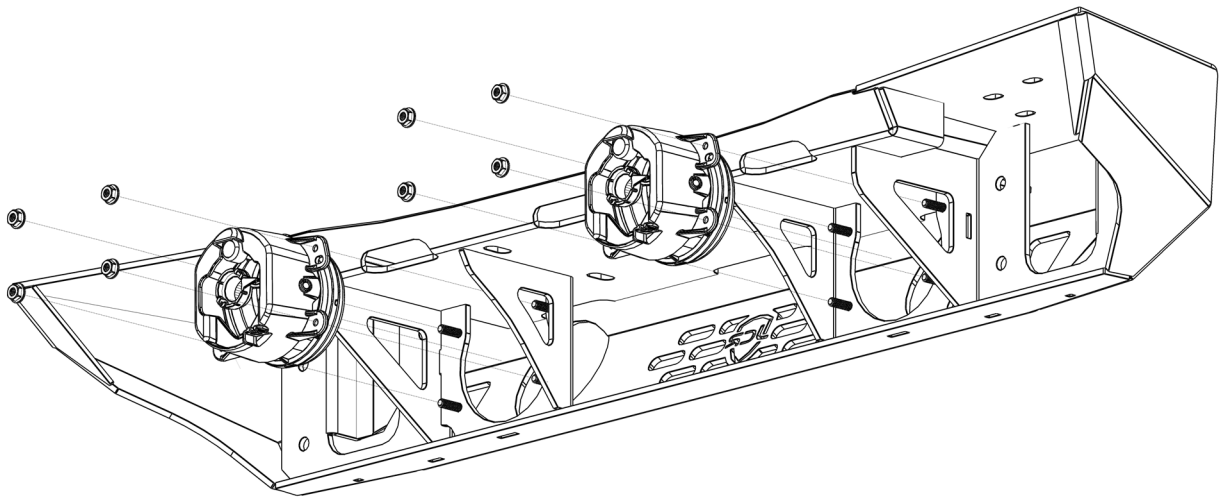

ASSEMBLY

4. With the fog lights secure, you now can bolt the pre-runner tube onto your bumper using the provided short 3/8" bolts and nuts. Be sure to assemble as shown in the orientation below, with the nuts on the inside of the bumper.

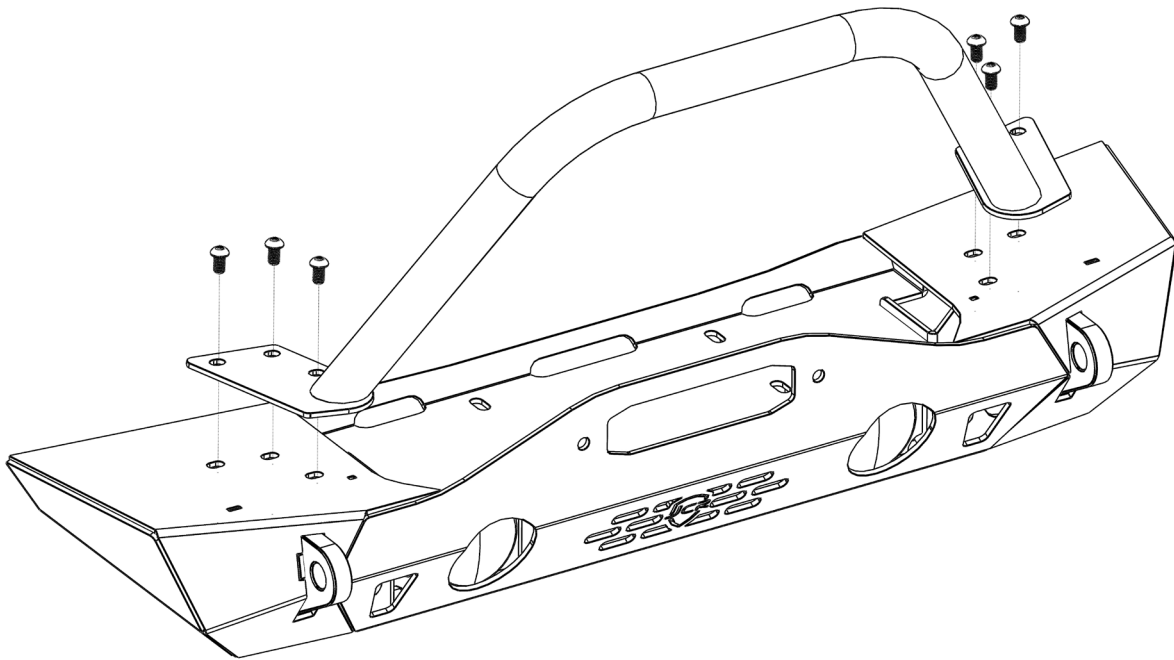

ASSEMBLY

5. Next before you put the bumper on your Jeep, you will need to drill out the driver side upper outer hole in the frame to $9/16$ " to acomodate the studs on the bumper to fit through (highlighted in red below).

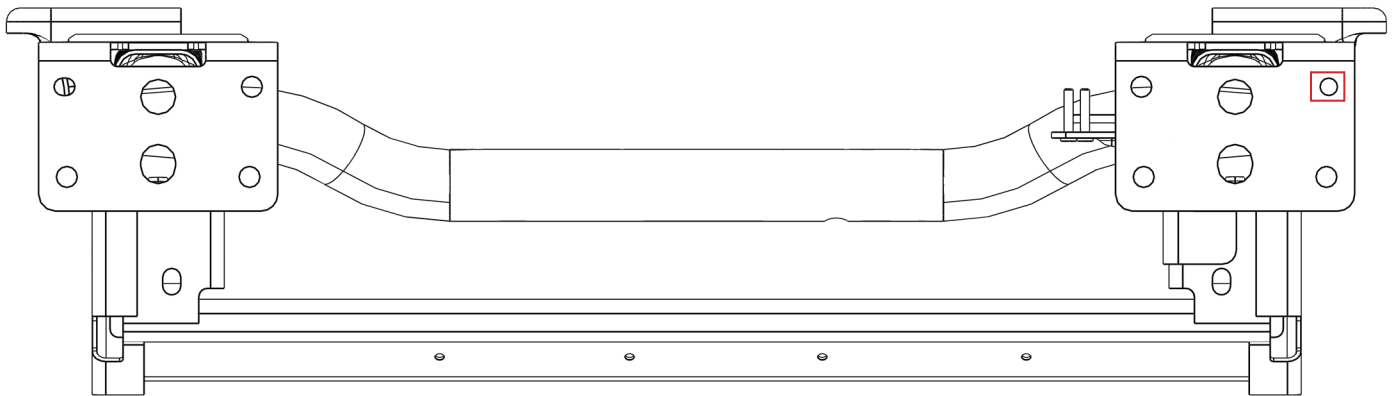

ASSEMBLY

6. Now that the hole is drilled out, you are ready to slide the bumper onto the frame through the set of (8) mounting holes, using the mounting studs on the bumper. Once you have the holes lined up and the bumper slid onto the frame, take the provided $7/16$ " nuts and thread them onto the studs as shown in the orientation below (view from the bottom), and tighten them down.

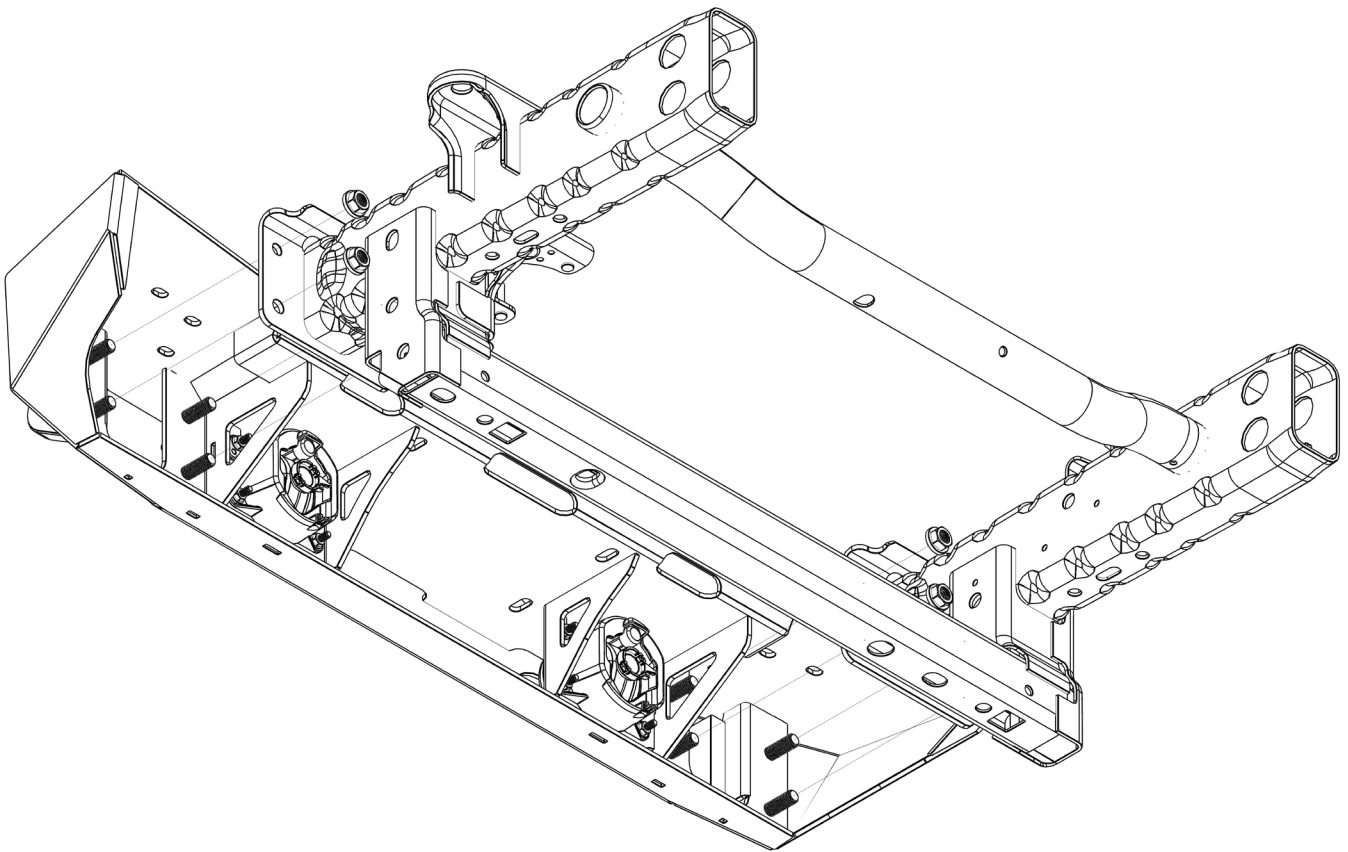

ASSEMBLY

7. Now that your bumper is on the Jeep, make sure all of your hardware is tight and secure to complete the install. You are now free to hook up and wire your fog lights and/or a winch to your choosing.

