

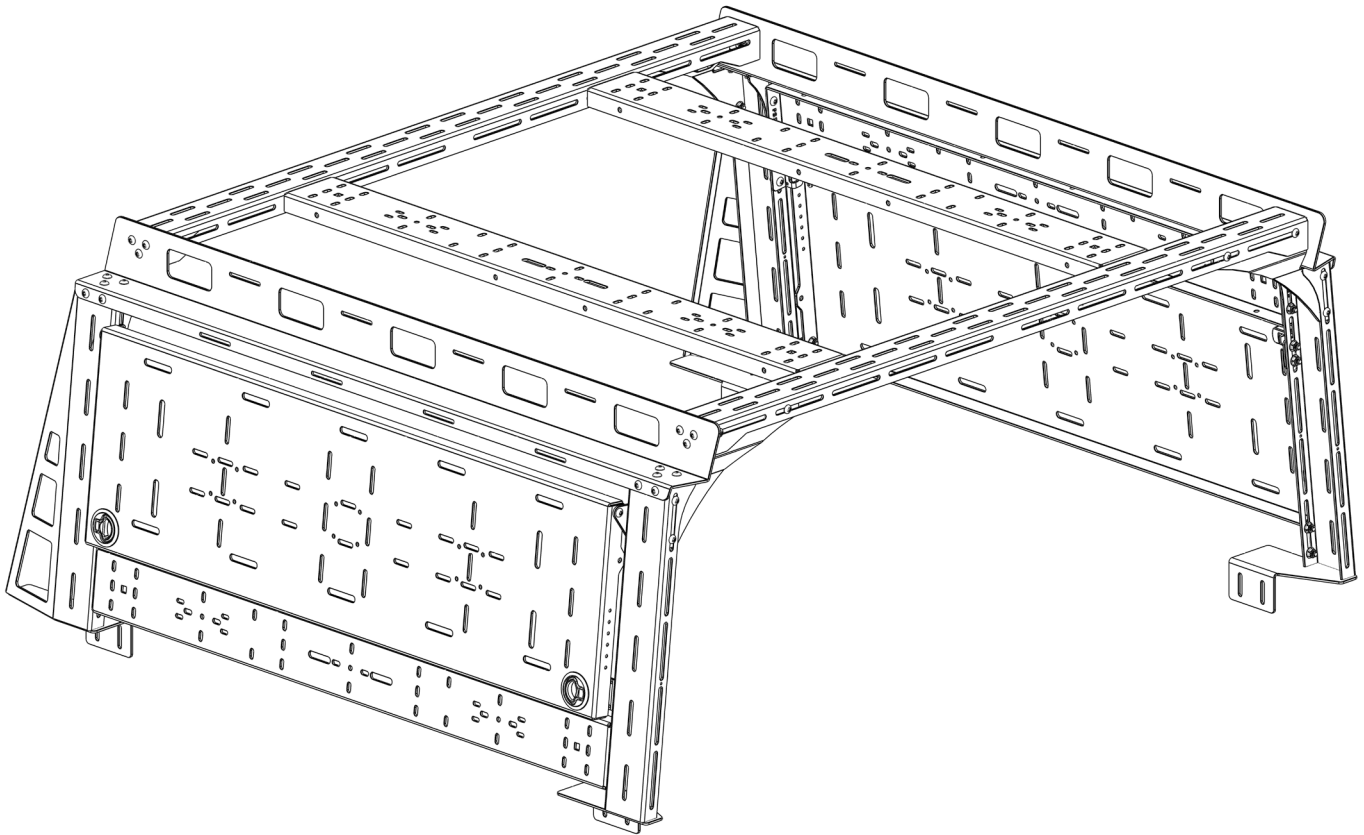

# JT

# OVERLAND BED RACK

## INSTALL INSTRUCTIONS



**Please read the mounting instructions below carefully before attempting to install.**

**Be sure to check out the install video on the product page, if available.**

Thank you for purchasing from JcROffroad! Checkout our website, [www.jcroffroad.com](http://www.jcroffroad.com) for other great off-road products. Be sure to rate and review our product online. If you have any questions or are missing parts, please don't hesitate to call us at 269-353-1184!

# INCLUDED HARDWARE

98x



5/16\"-18 X 3/4\"  
Button Head

10x



5/16\"-18 X 1\"  
Button Head

10x

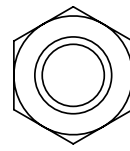

5/16\"-18  
Nylock Nut

8x

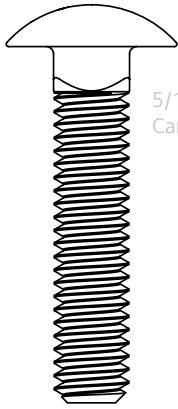

5/16\"-18 X 1-1/2\"  
Carriage Bolt

4x

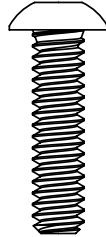

10-24 X 3/4\"  
Button Head

8x

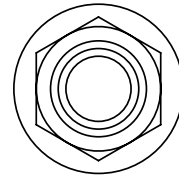

5/16\"-18  
Flanged Nylock Nut

4x

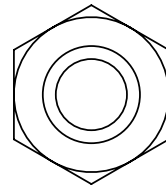

M8 X 1.25mm  
Nylock Nut

16x

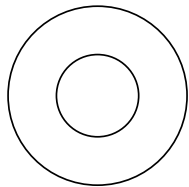

5/16\"  
Nylon Plastic Washer

8x

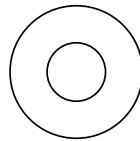

#10  
Nylon Plastic Washer

8x

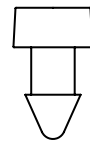

5/16\"  
Rubber Push-In Bumper

96x

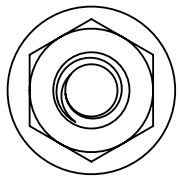

5/16\"-18  
Serr. Flange Nut

8x

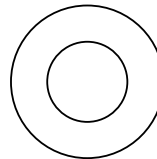

M8  
Washer

8x

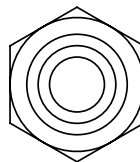

10-24  
Nylon Lock Nut

# INCLUDED PARTS

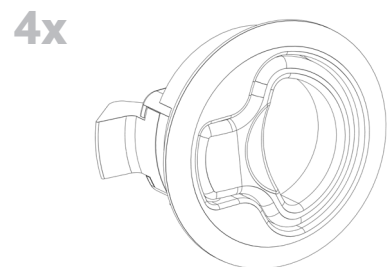
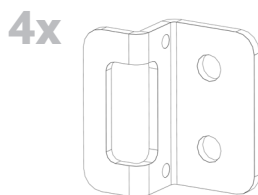
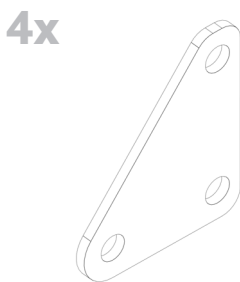
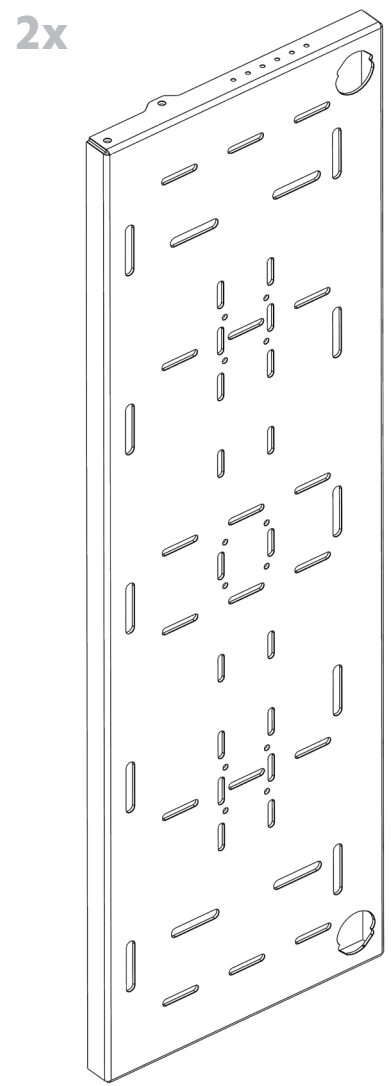
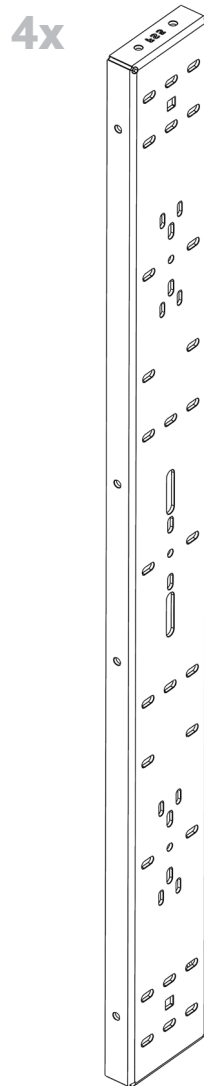
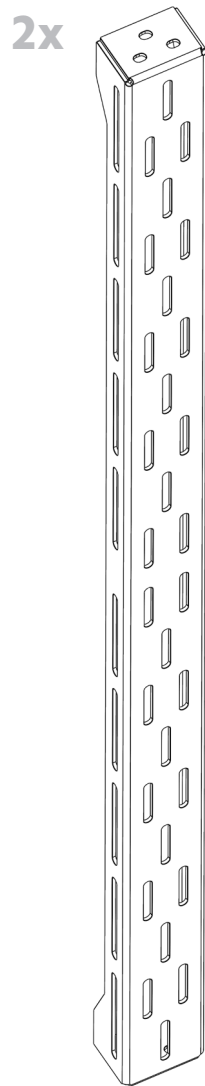
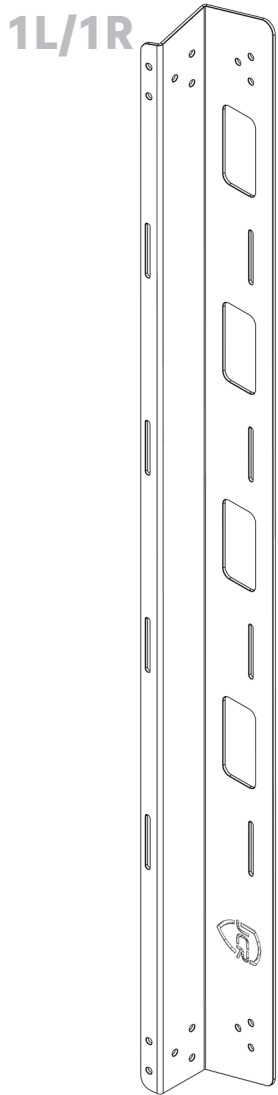

# INCLUDED PARTS

1L/1R

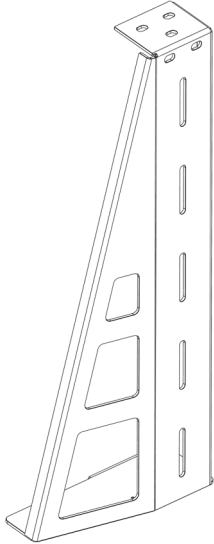

1L/1R

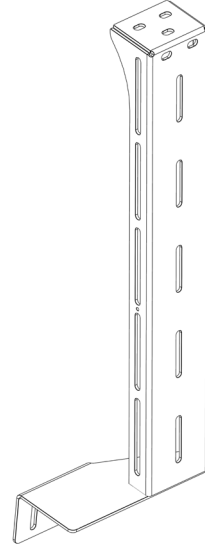

4x

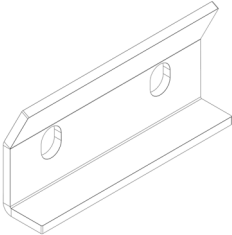

4x



4x

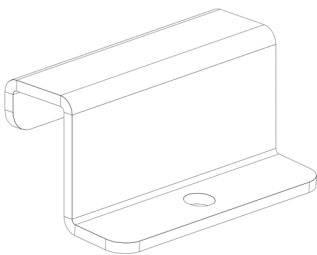

4x

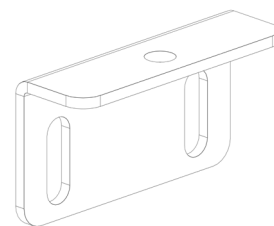

1L/1R

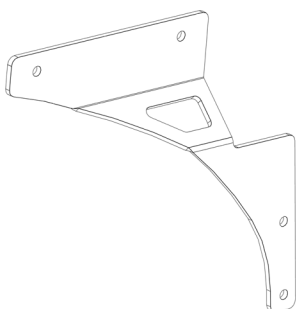

1L/1R

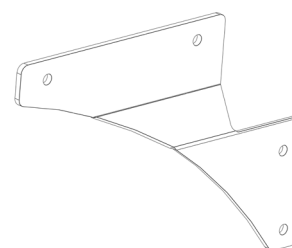

# ASSEMBLY

- 1 Start by loosely mounting the top rail to the corresponding front and rear legs using the 5/16"-18 x 3/4" button head bolts and 5/16"-18 serr. flange nuts. The side rail should sit on the top of the legs with the small slotted flange pointing down along the side of the legs. The side rail bolts into the top of each leg as well as the side of each leg. Make sure that you have the legs oriented so that if you were to set them onto the side of the bed, the wing of the rear leg and the mounting plate of the front leg are towards the rear. Also, make sure that the top edge of the side rail is angled towards the front so that the top edge hangs over the front of the front leg.

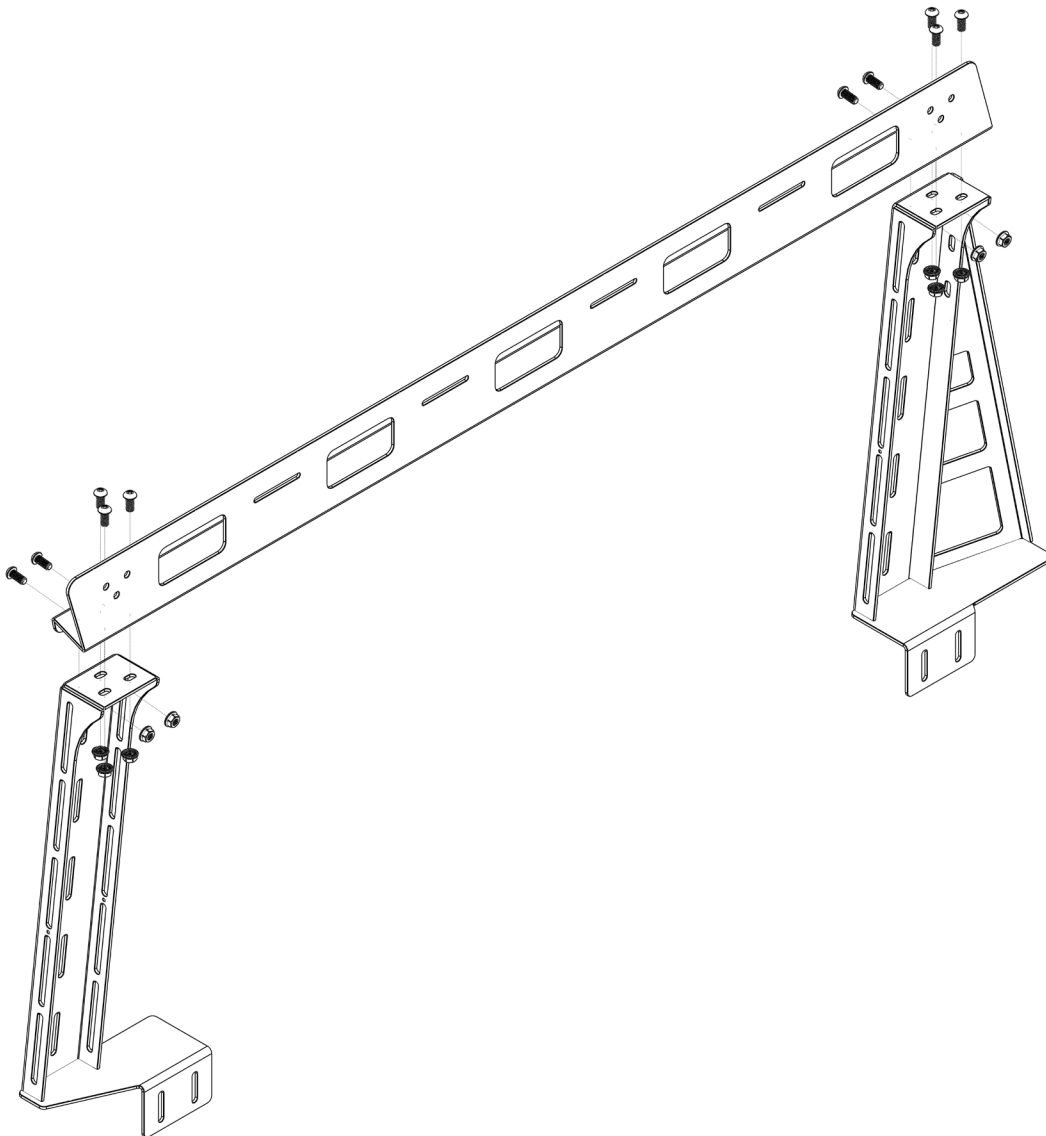

# ASSEMBLY

- 2 Next, mount two of the wider bars between the front and rear legs using the 5/16"-18 x 3/4" button head bolts, 1/4" washers and 5/16"-18 serr. flange nuts. You will see that there are several mounting options for this bar. The position that you put these bars in will be dependent on if and where you want the doors to be installed and which way you want them to open. If you want the door to open up, you can put this bar in the top or bottom slot. If you want the door to open down, you will have to put this bar in the top slot. Once you have that tightened into place, you can tighten the bolts on the top rail as well.

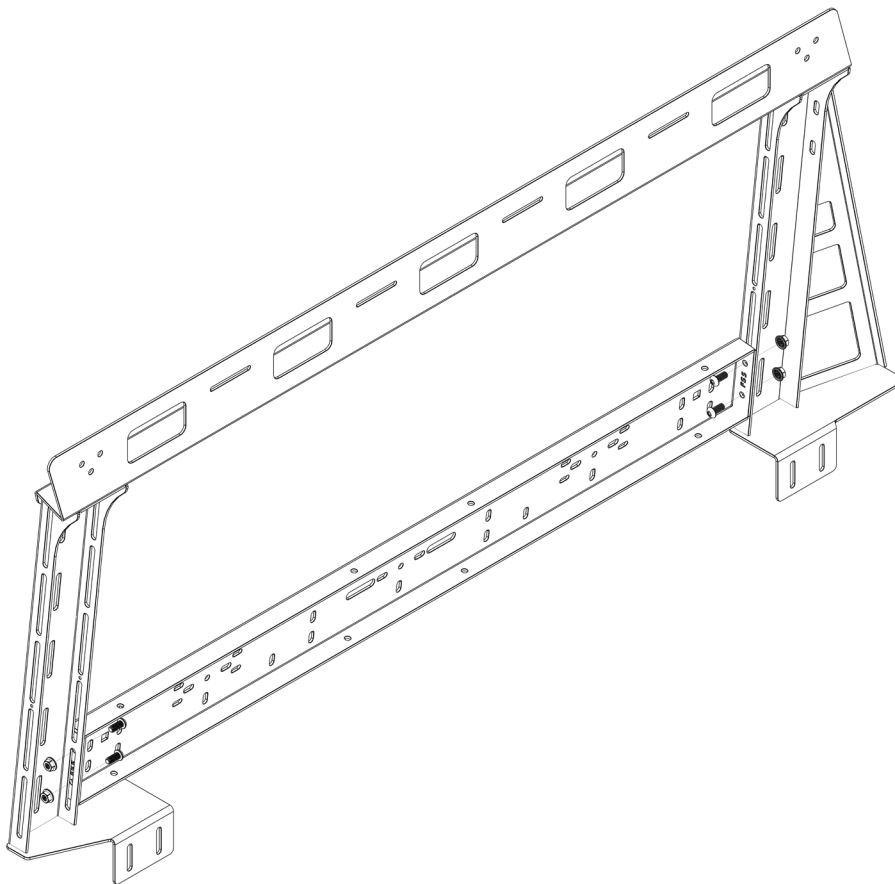

# ASSEMBLY

- 3** Next, connect the two sides you assembled together using the thinner cross bars with 5/16"-18 x 3/4" button head bolts and 5/16"-18 serr. flange nuts to mount them in position. One bar will mount to the front of the top rail, and one will mount to the rear. The open side should be on the bottom.

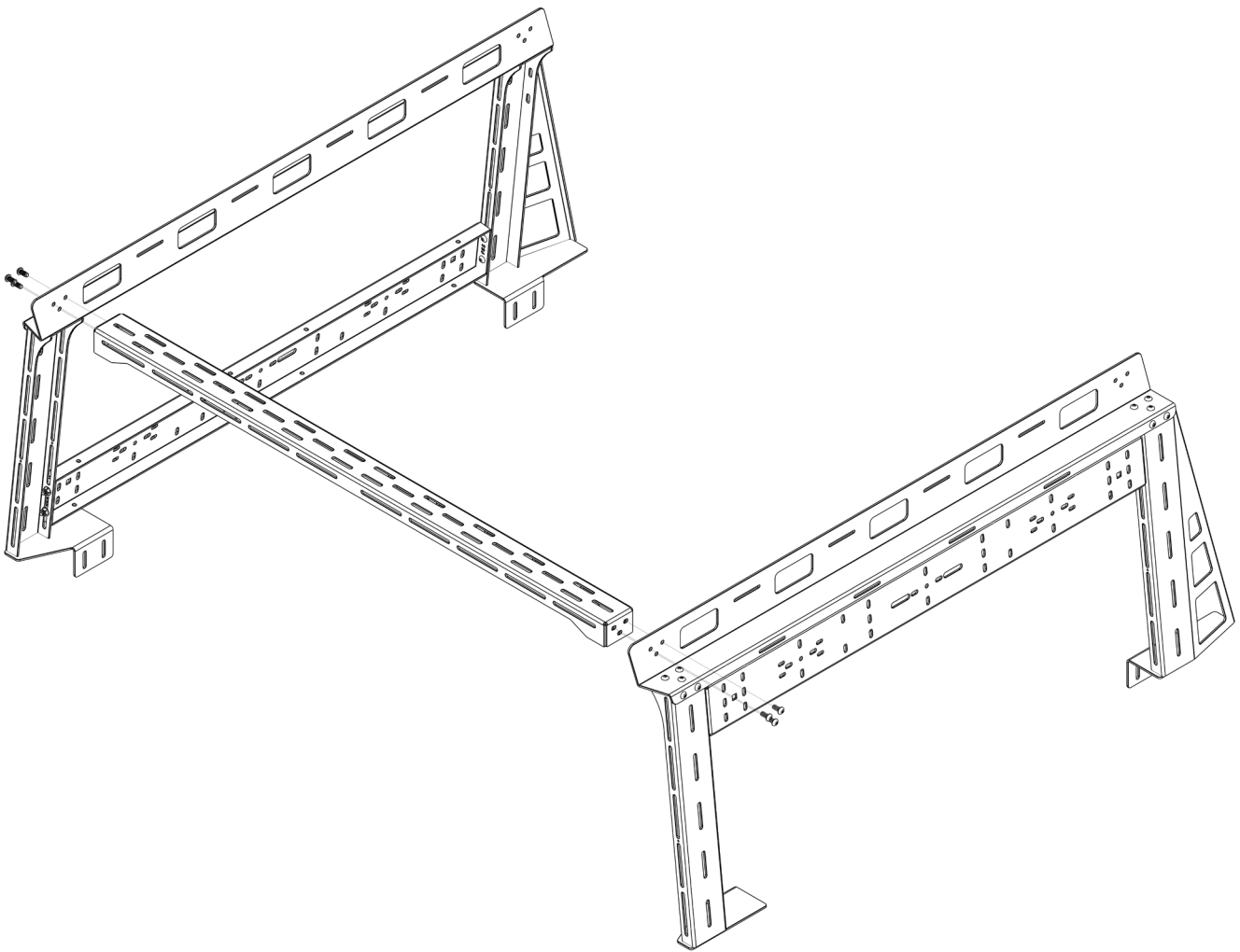

# ASSEMBLY

- 4 Next, mount the two remaining wider bars to the top of the rack between the bars you just installed. Do this using the 5/16"-18 x 3/4" button head bolts and 5/16"-18 serr. flange nuts. Which slots you mount them to is up to you and what you plan to use them for. Shown below is an image of the passenger side bar being installed from an underside view.

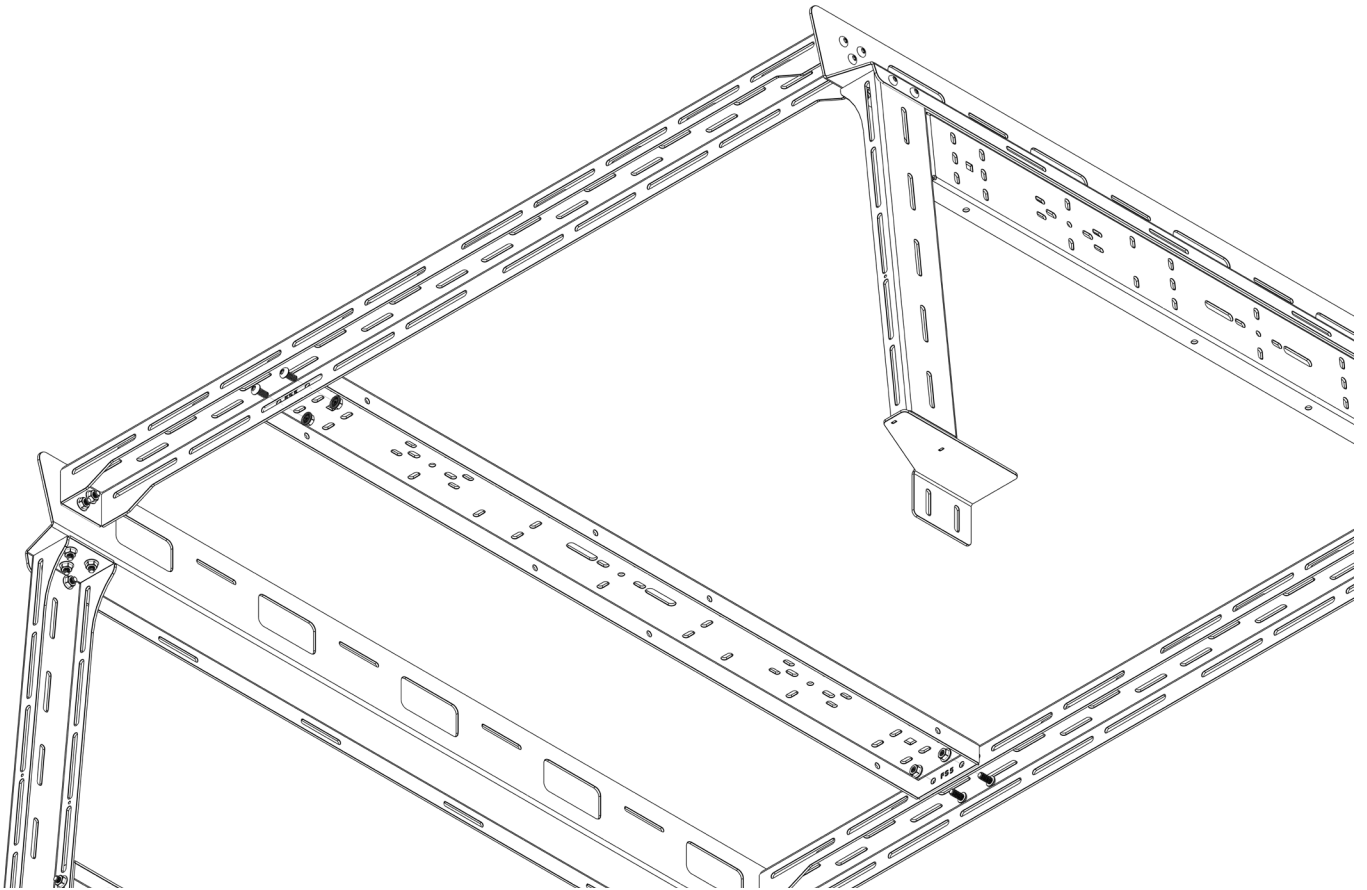



# ASSEMBLY

- 5** With the rack assembled, you can place it onto the bed of your vehicle. How you mount it depends on whether or not you have the trail rail system in the bed of your Gladiator. If you do, simply insert a 5/16"-18 x 1-1/2" carriage bolt through each hole in the small rectangular spacer and slide that into the trail rail. Do that three more times, then you can mount the legs of the bed rack using the 1/4" washers and 5/16"-18 flanged nylock nuts.

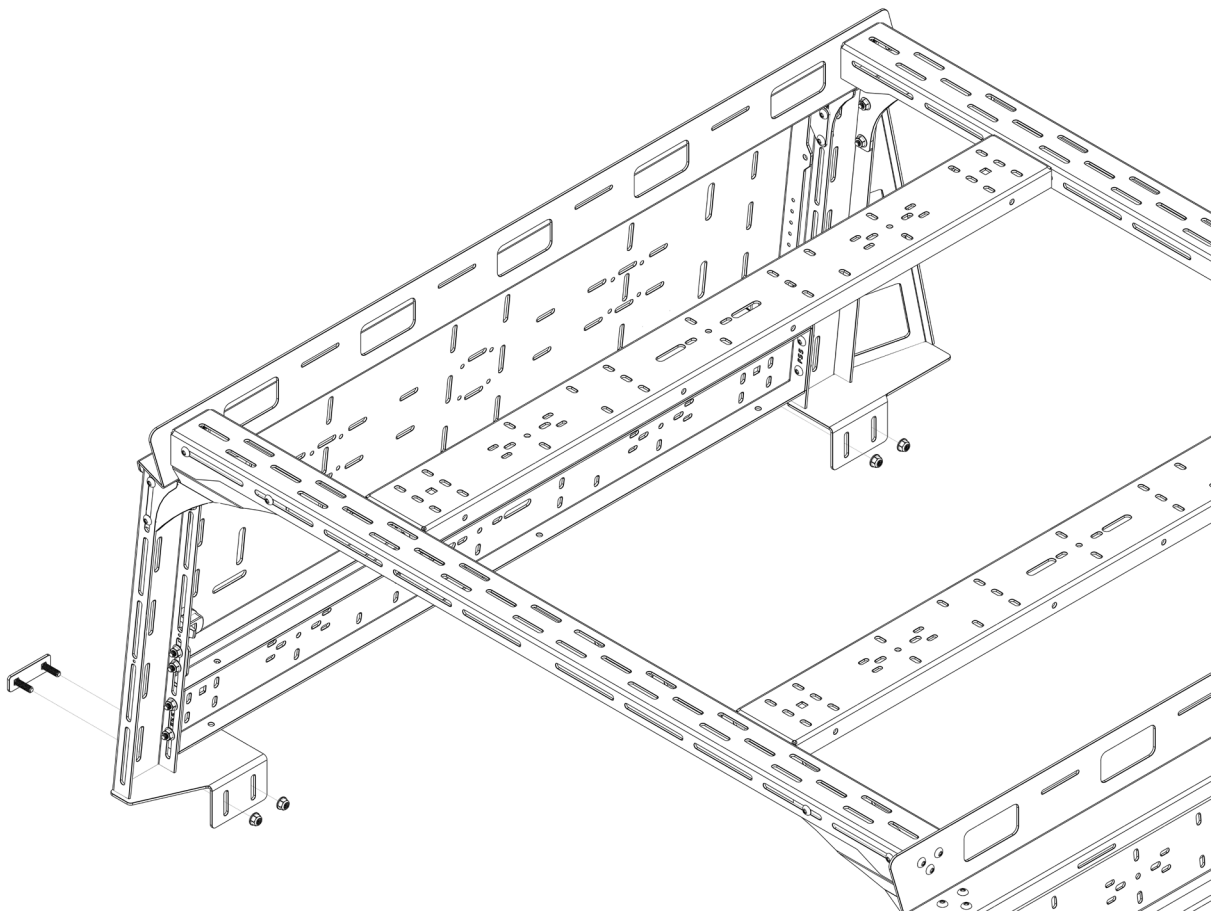

# ASSEMBLY

- 6 If you do not have the trail rail, you will need to clamp the legs to the bed, to do so, loosely attach the c shaped bracket to the back of the bottom of each of the legs using the 5/16"-18 x 1-1/2" carriage bolts and 5/16"-18 flanged nylock nuts. Make sure the 90-degree bend is on the bottom and the carriage bolts go through the back side of the c shaped bracket. Finally, push the c shaped brackets up until the edge of the bed is between the brackets and the bottom of the legs and tighten them all into place, clamping the bed rack onto the bed. Try to tighten each bolt evenly in order to best secure the bed rack.

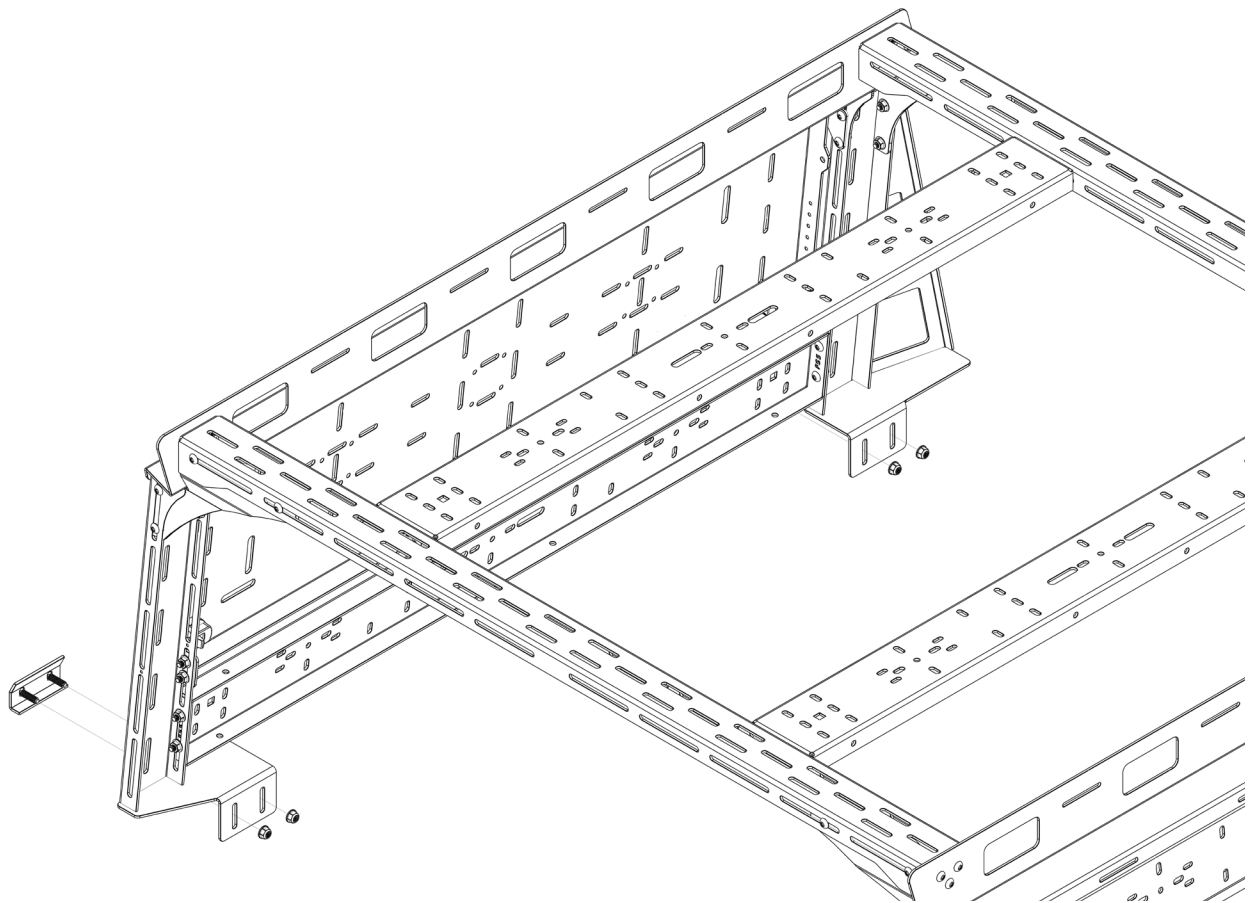

# ASSEMBLY

- 7** With the rack and soft topper in place, you can install the corner support brackets using the 5/16"-18 x 3/4" button head bolts and 5/16"-18 serr. flange nuts. The rear bracket is the one with the hole cut out of the middle of it. The rear brackets mount to the slots on the inside of the leg and the inside of the top cross bar. Make sure that the bolts going into the rear leg go out through the inside of the rear leg so that you have room to get to the head of the bolt. The front brackets can mount to the inside or outside, but we recommend mounting them to the outside because it can be easier.

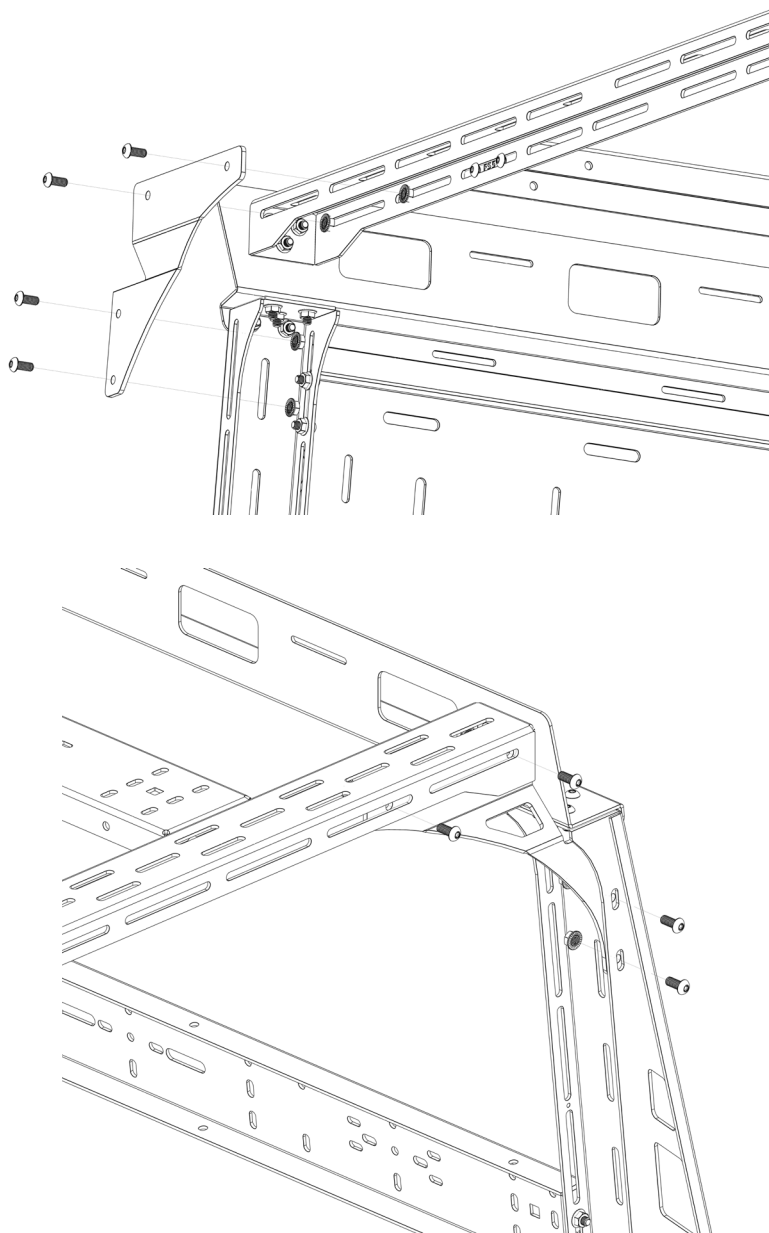

# ASSEMBLY

- 8** Next you can get started on installing the doors if you are choosing to do so. Start by installing the triangular hinge brackets into the slots necessary for where you want your doors on the inside of the legs using the 5/16"-18 x 3/4" button head bolts and 5/16"-18 serr. flange nuts. If you want the door to flip down, install them in the bottom slots. If you want the door to be above the side bar and flip up, install them in the top slots. If you want the door to be below the side bar and flip up, install them in the second slots from the top. No matter where you put the hinges, make sure that the hole that mounts the door is towards the top and outside of the rack. Shown below is an image of the installation of a hinge for a door that flips up, above the side bar.

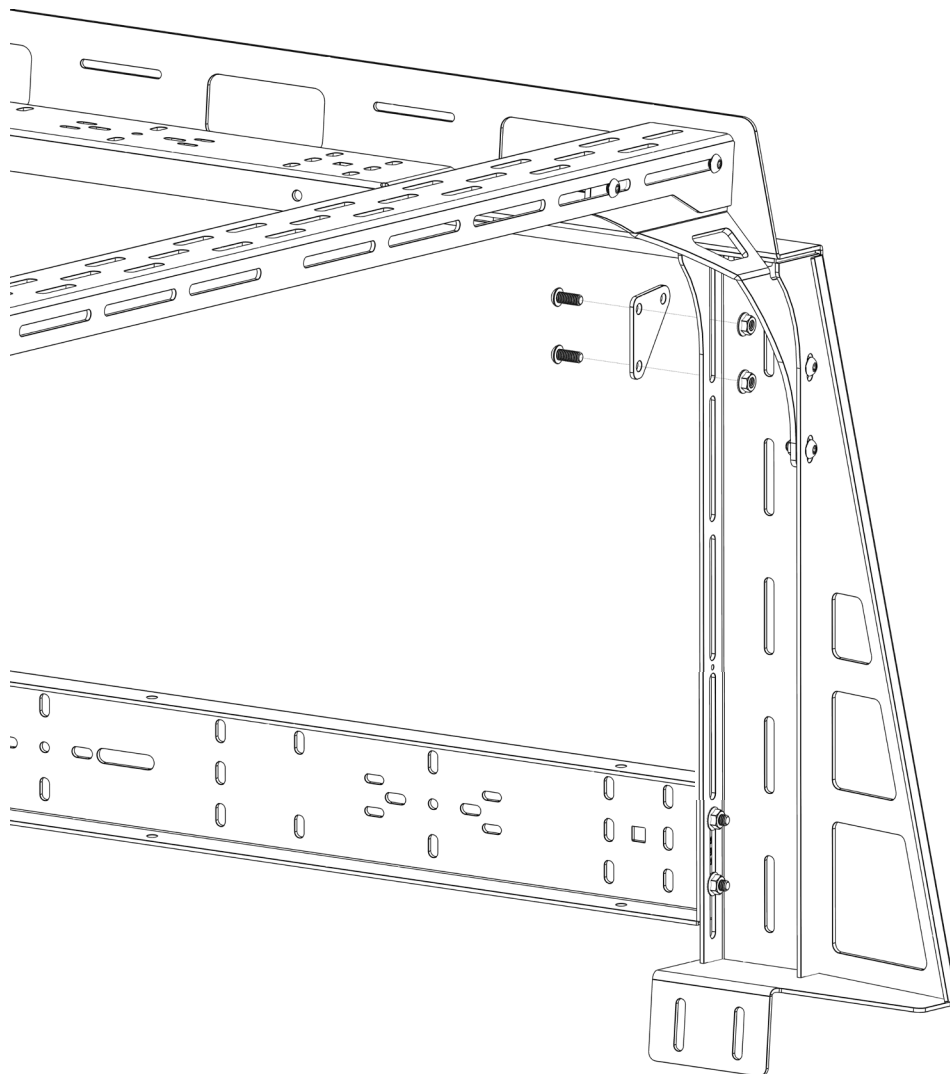

# ASSEMBLY

- 9 Next, mount the latch brackets roughly where the latch of the door will land when closed. You will most likely need to move them later so just get them in the general area. The latch brackets should be positioned so that when they are bolted into place, the other side sticks in towards the door and then out towards the outside of the rack. Either before or after mounting the latch bracket, insert the 5/16" rubber bumpers into each of the two small hole in each bracket. Make sure the cushion part sits where the edge of the door will land.

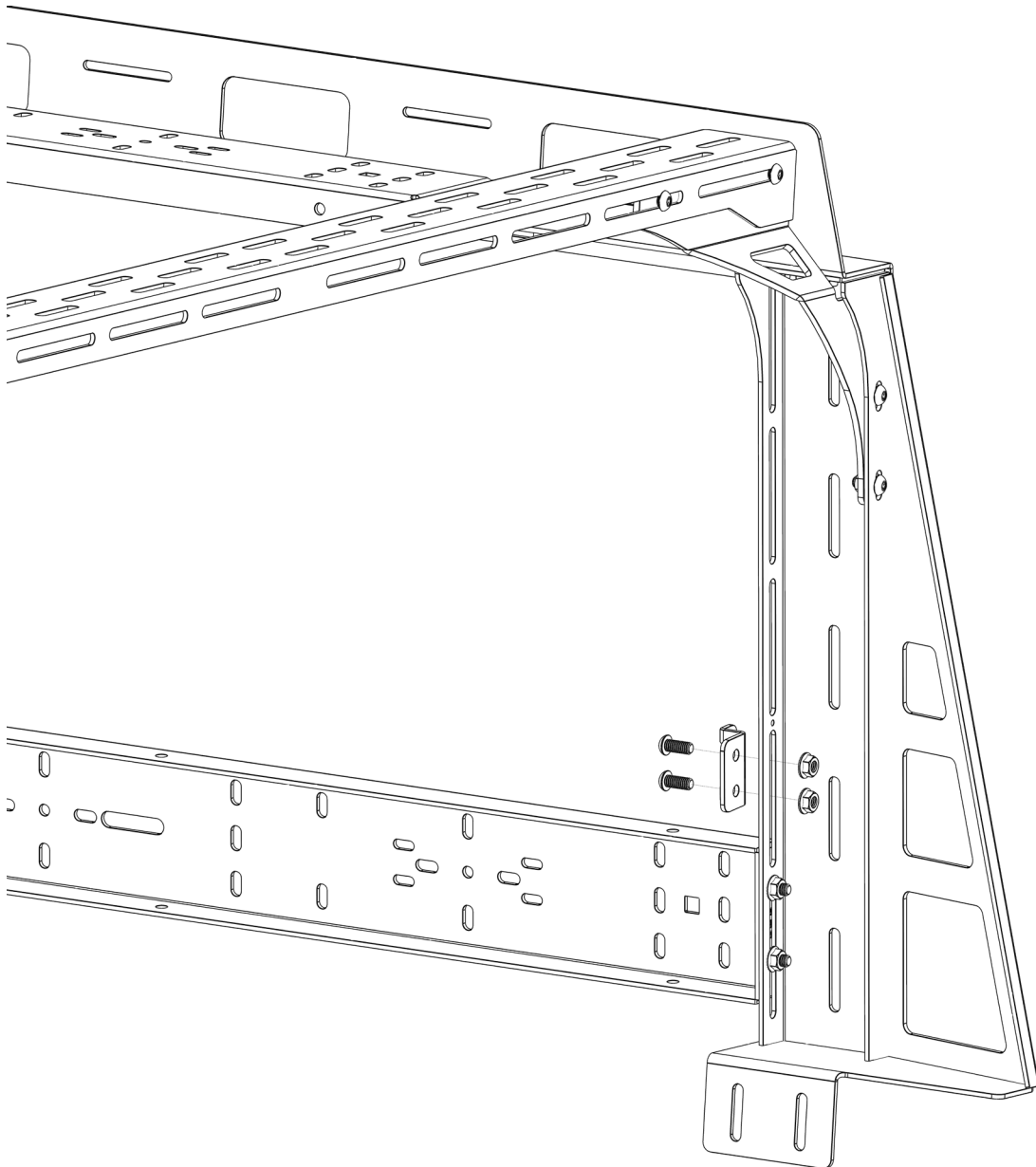

# ASSEMBLY

- 10** Next, mount the latches to the holes in the doors. To do this, start by removing the metal back cover from the latch. Then, put the latch into the hole in the door through the front and place the metal back piece back onto the latch from the inside of the door, sandwiching the door between them. Then, use the provided bolt, washer and lock washers to tighten the back against the inside of the door.

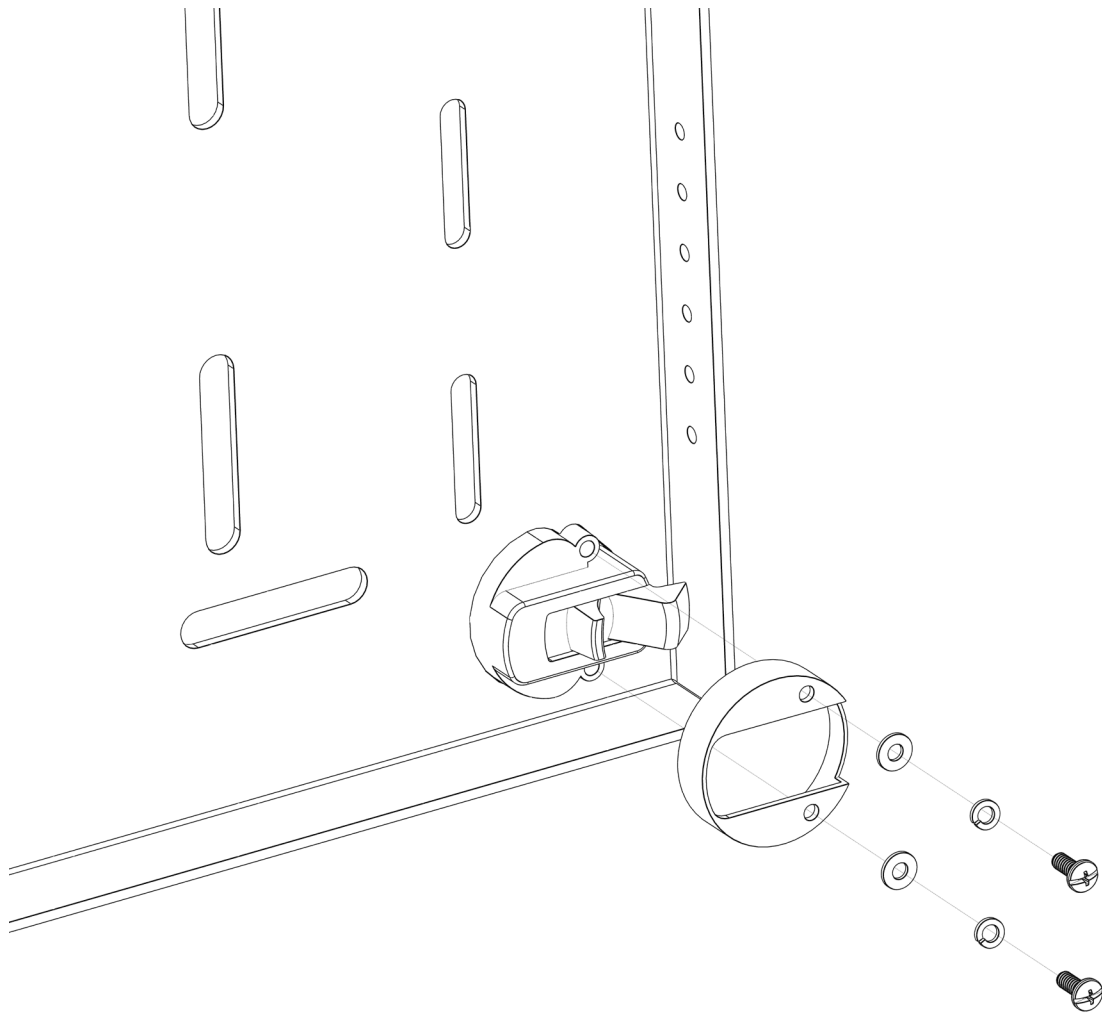

# ASSEMBLY

- 11** Next, mount the doors to the hinges using the 5/16"-18 x 3/4" button head bolts, 5/16" nylon washers and 5/16"-18 nylock nuts. The door bolts in between the hinges with a nylon washer between the hinge and the door as well as the door and the nut. You will want to tighten the bolts to the point that they won't rattle, but you are still able to rotate the door.

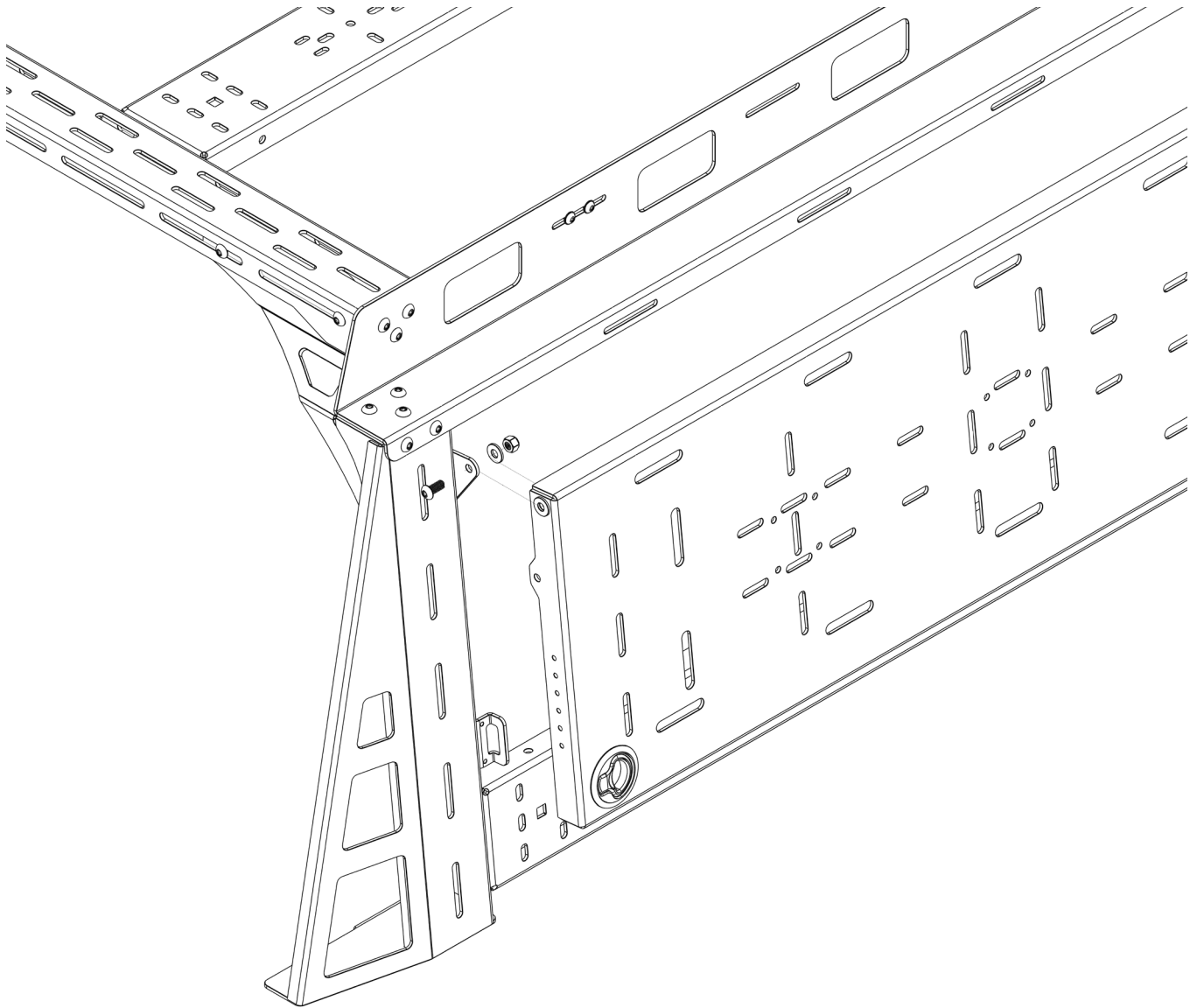

# ASSEMBLY

- 12** Next, attach either the gas struts or the lanyards depending on which way your door is going to open. If it is going to open up, you will need to attach the gas struts (step 13). If it is going to open down, you will need to attach the lanyards (step 14).
- 13** For the door that opens up, pull the top bolt out of the latch bracket and bolt the gas strut in through that hole using the threaded end and a 5/16"-18 serr. flange nut. Then attach the other end to the large hole in the door using a 5/16"-18 X 1" button head bolt, three nylon washers and a nylock nut. One washer goes between the head of the bolt and the door and the other two go between the door and the strut.

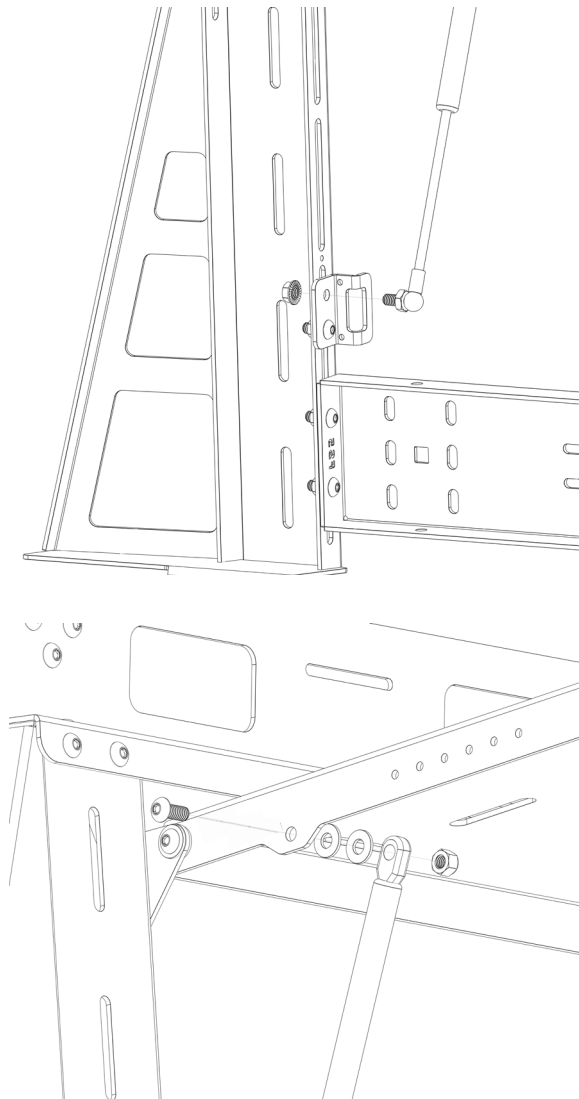



# ASSEMBLY

- 14** For the door opens down, attach one end of the lanyard to the hole in the middle of the leg using a 10-24 X 3/4" button head bolt, a #10 nylon washer and a 10-24 nylock nut. Then attach the other end to the inside of the door using the same hardware. Make sure the flat end of the eye of the lanyard sits against the nylon washer. The different holes in the door are there to give you options for how wide you want it to open.

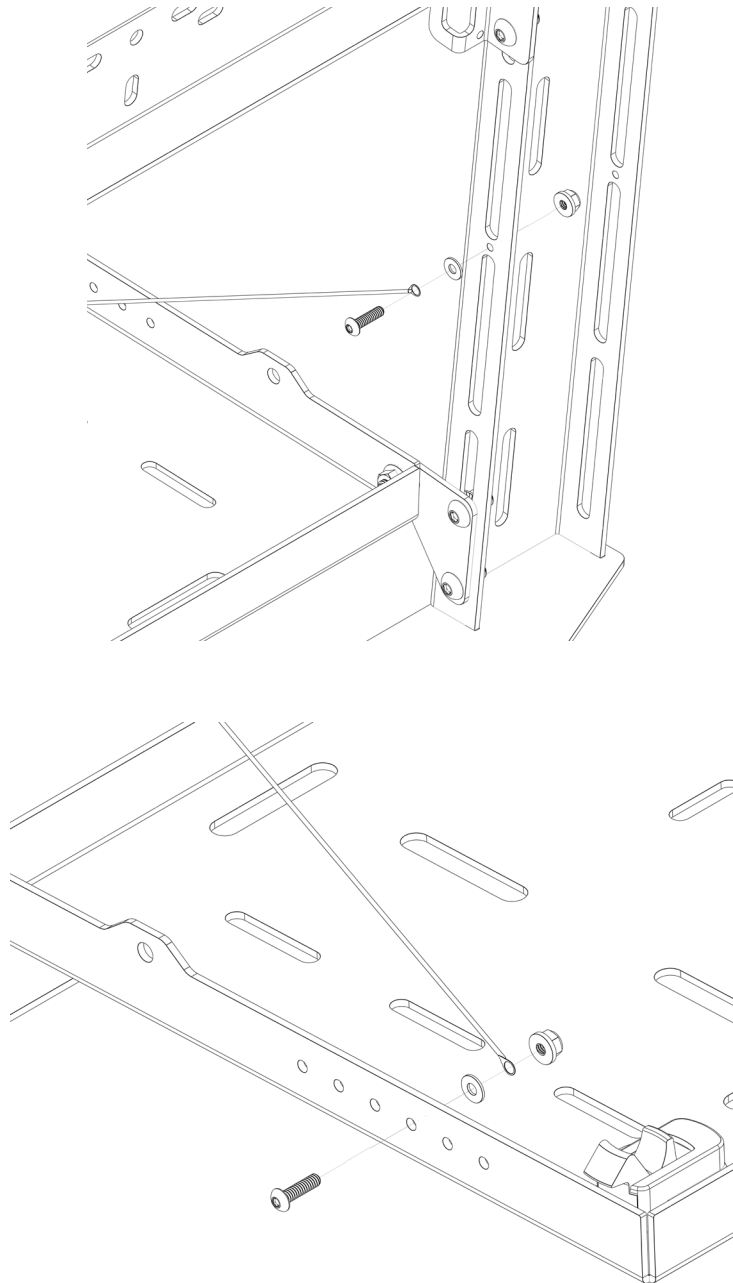

# ASSEMBLY

- 15** Next, if you have installed a soft topper, undo the nuts on the bolts for the clamps on leg. Next, place the hook shaped soft topper bracket into the hole in the rail of the soft topper and hold the other soft topper bracket underneath it so that the holes on the two line up and the carriage bolts go through the slots in the bottom bracket. Once they are oriented correctly, move the bottom bracket roughly 1/8" down and tighten it into place. Then, with the upper bracket still hooked into the channel on the soft topper, use a 5/16"-18 X 3/4" bolt, M8 washer and 5/16"-18 nylock nut to tighten the two soft topper brackets together. Make sure that they sit flat against each other. We recommend getting some rubber weather stripping to line the bottom edge of the soft top in order to get it as weather tight as possible.

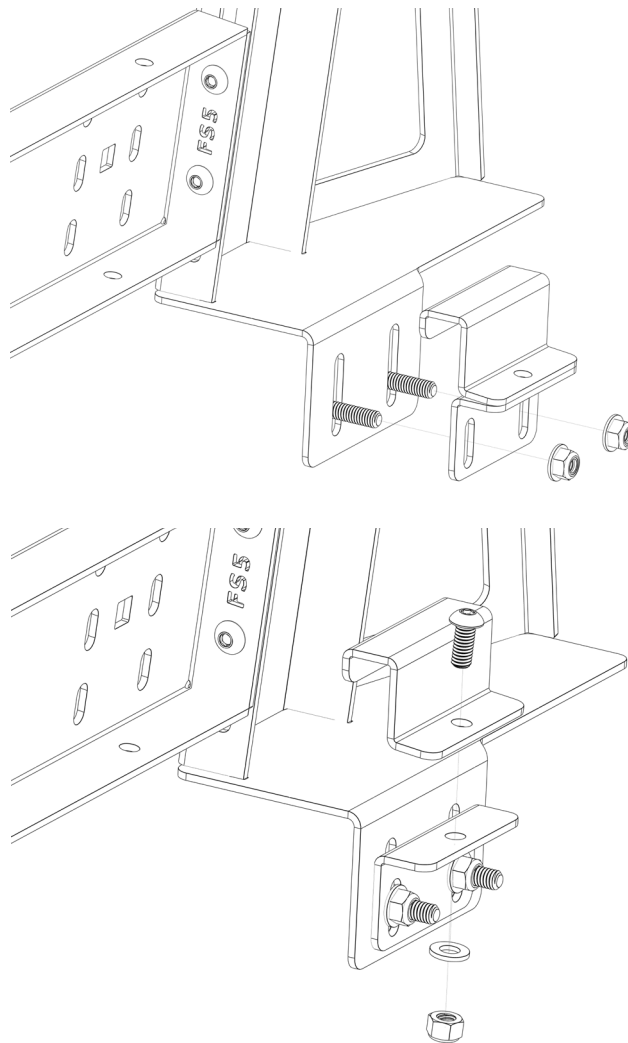

# DIMENSIONS

