

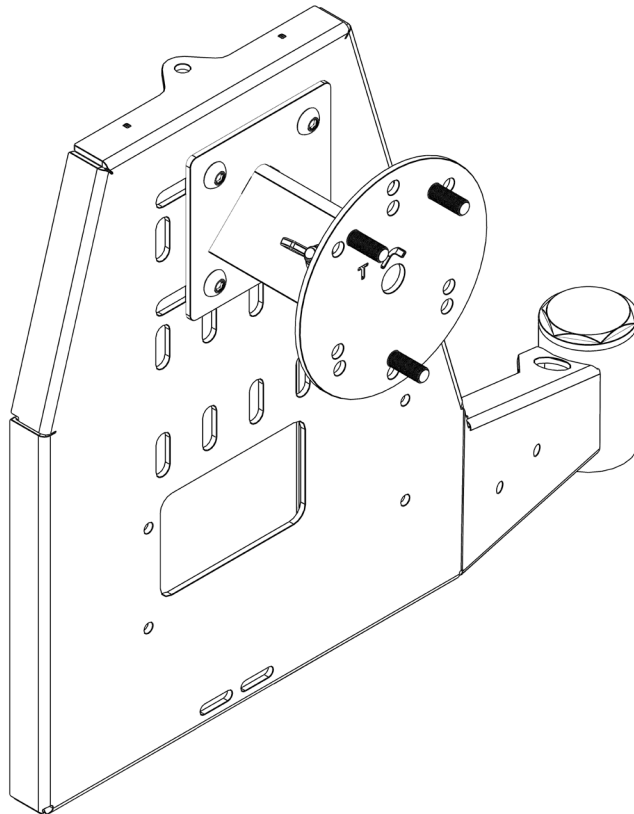

UNIVERSAL TIRE MOUNT

INSTALL INSTRUCTIONS



Please read the mounting instructions below carefully before attempting to install.

Be sure to check out the install video on the product page, if available.

Thank you for purchasing from JcROffroad! Checkout our website, www.jcroffroad.com for other great off-road products. Be sure to rate and review our product online. If you have any questions or are missing parts, please don't hesitate to call us at 269-353-1184!

INCLUDED HARDWARE

4x

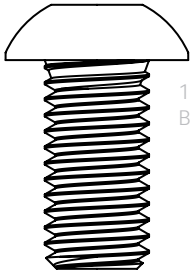

1/2"-13 X 1"
Button Head

4x

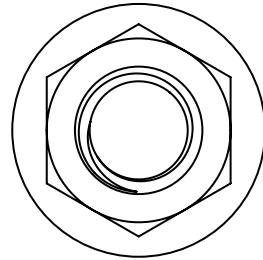

1/2"-13
Serr. Flange Nut

2x



3/8"-16 X 3/4"
Carriage Bolt

2x

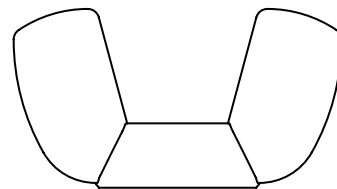

3/8"-16
Wing Nut

3x



1/2"-20 X 1-1/2"
Wheel Bolt

3x

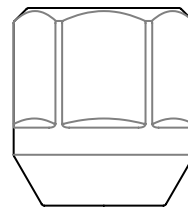

1/2"-20
Acorn Lug Nut

2x

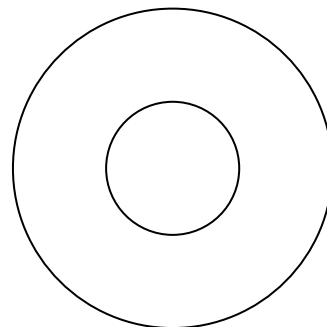

9/16"
USS Flat Washer

INCLUDED PARTS

1x

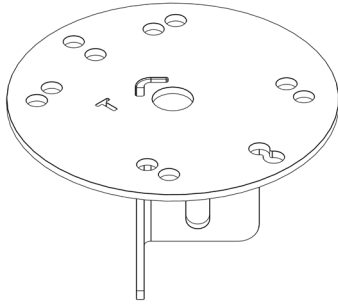

OR

1x

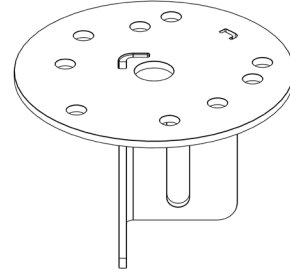

1x

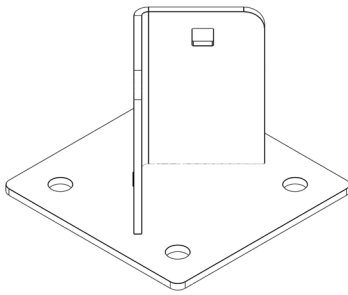

ASSEMBLY

- 1** Decide on the placement of your tire mount (if mounting to an Adventure Carrier). Bolt the carrier side of mount on using four hex head bolts and flange nuts. Tighten them down using a 3/4" end wrench and socket.

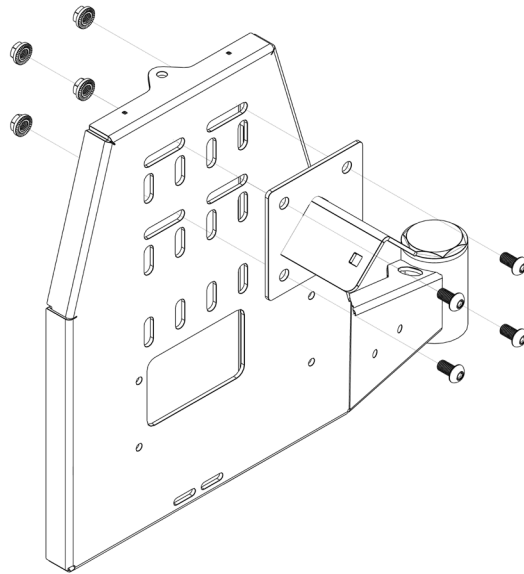

- 2** Now install the wheel studs in the tire side of the mount. There are multiple bolt patterns on this mount so check the diagram below to find the one that works with your spare. You can also hold the mount up to your wheel to see which pattern lines up. Place the wheel stud in through the back of the mount and add 2 washers and a lug nut (backwards) as shown. Tighten the lug nut until the stud is fully seated in the tire mount, then remove the lug nut and washers.

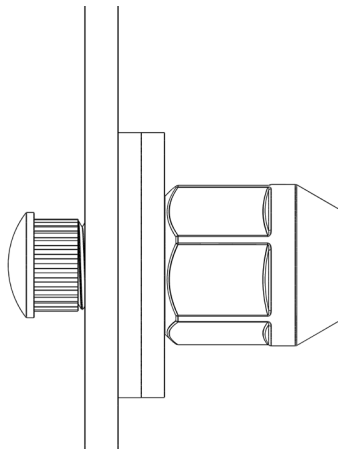

ASSEMBLY

- 3** Loosely bolt the tire side of the mount to the carrier side using two carriage bolts and flange nuts.

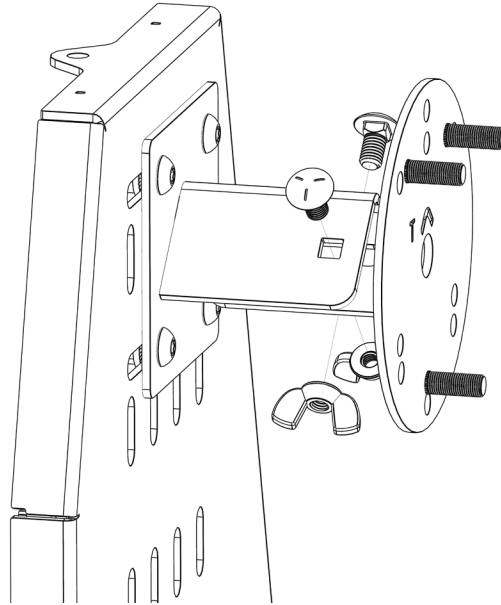

- 4** Now measure the backspacing of your spare tire (wheel backspacing + tire bulge), to set the correct depth on the tire mount. Place the tire face down on the ground. Lay a straight edge of some kind (broom, level...) across the center. Measure up from the mounting surface of the wheel to the bottom of the straight edge. Take this measurement and subtract 1/8" so that there will be a little bit of squeeze on the tire when it is mounted. Set the tire mount to this measurement (from carrier to the face of the mount) and tighten down the carriage bolts.

ASSEMBLY

- 5** If you are installing our license plate/camera relocation, you will need to put the inside portion of that bracket on now. Then install your spare and tighten everything down.

*Supplied with 1/2"-20 acorn lug nuts (uses 13/16" socket.) Depending on wheel, different nuts may need to be sourced. For factory Toyota wheels, use Gorilla Automotive 72187 short shank lug nuts.

Tire mount works with a maximum of 5" wheel backspacing. Use of a spacer will be necessary on any wheels with more than 5" of backspacing.

